



Canadian Public Health Association 2008 Annual Conference

Public Health in Canada:
Reducing Health Inequalities
Through Evidence and Action

World Trade and Convention Centre
Halifax, Nova Scotia • 1-4 June 2008



FINAL PROGRAM

Collaborators



Canadian Public Health Association (CPHA) – is a national, independent, not-for-profit, voluntary association representing public health in Canada with links to the international public health community. CPHA's members believe in universal and equitable access to the basic conditions which are necessary to achieve health for all Canadians.



Canadian Institute
for Health Information
Institut canadien
d'information sur la santé

Canadian Institute for Health Information – Canadian Population Health Initiative (CIHI-CPHI) – CPHI, a part of CIHI, has as its mission to foster a better understanding of factors that affect the health of individuals and communities, and to contribute to the development of policies that reduce inequities and improve the health and well-being of Canadians.



Canadian Institutes of Health Research – Institute of Population and Public Health (CIHR-IPPH) – IPPH supports research into the complex interactions that determine health, and its application to improve the health of individuals, communities and global populations. IPPH is one of 13 institutes of the Canadian Institutes of Health Research. CIHR is Canada's major federal funding agency for health research. Its objective is to excel, according to internationally accepted standards of scientific excellence, in the creation of new knowledge and its translation into improved health for Canadians, more effective health services and products, and a strengthened Canadian health care system.



Public Health
Agency of Canada

Agence de la santé
publique du Canada

Public Health Agency of Canada (PHAC) – The Public Health Agency of Canada's role is to help build an effective public health system in Canada – one that allows Canadians to achieve better health and well-being in their daily lives, while protecting them from threats to their health security.



National Collaborating Centres
for Public Health
Centres de collaboration nationale
en santé publique

National Collaborating Centres (NCC) for Public Health – are a key part of the federal government's strategy to support public health renewal in Canada. The NCCs build on existing strengths to improve the use of scientific and other knowledge to enhance the effectiveness and efficiency of Canada's public health system. They make useful research available and accessible to public health practitioners, foster linkages among researchers, the public health community and other stakeholders, and promote the sharing of knowledge across this network to strengthen public health practice across Canada. They are located in different regions across the country, each one specializing in a priority area.

This conference is presented in association with:



Public Health Association of Nova Scotia (PHANS) - is a voluntary not-for-profit organization, affiliated with the Canadian Public Health Association. PHANS believes health is a product of a healthy community, healthy economy and healthy environment. By advocating for policy change, our mission is to work towards a society that supports this broad vision of health for Nova Scotia.

Welcome!



On behalf of the Canadian Public Health Association (CPHA), I am pleased to welcome you to our 2008 Annual Conference. We have developed an engaging program for you with the support of our conference collaborators: the Canadian Institute for Health Information - Canadian Population Health Initiative (CIHI-CPHI), the

Canadian Institutes of Health Research - Institute of Population and Public Health (CIHR-IPPH), the National Collaborating Centres for Public Health (NCCs) and the Public Health Agency of Canada (PHAC). This year we are also pleased to host the conference in association with the Public Health Association of Nova Scotia (PHANS). These partnerships demonstrate the strong links between research, policy and practice.

This conference represents the largest annual gathering of public health experts in Canada, bringing together key public health players from professional associations, non-governmental organizations, academia and various levels of government. Our theme – *Public Health in Canada: Reducing Health Inequalities Through Evidence and Action* – challenges us to work together to build a foundation for structural changes to a broad array of policies and practices that reduce health inequalities and improve the lives of Canadians.

This year's theme has struck a chord with the public health community, resulting in the submission of over 450 abstracts. Although there was only room for just over 200 sessions, the reviewers and review committee were impressed by the consistently high quality of all the abstracts. The increased interest in all aspects of public health is driving the increasing demand for presentations at our conference and, as a result, public health in Canada is in a better position than ever before.

This conference is an opportunity to join friends and colleagues, old and new, for stimulating and informative discussions, sharing our ideas and visions for collaborative approaches to address public health in Canada. I thank all who have contributed to planning this excellent program, and I look forward to sharing these days of inspiration and fun. By working together, we can start to effectively address health inequalities and to work towards building healthier communities and a healthier world.

Sincerely,

Ron de Burger, Chair, CPHA

Sponsors

The Canadian Public Health Association recognizes the generous support of the following organizations:

Platinum

Reckitt Benckiser

Gold

IBM Canada, Ltd.

Silver

Merck Frosst Canada
Nova Scotia Health Research Foundation
sanofi pasteur



General Information

Canada has made significant contributions to our global understanding of what determines health and human development across the life course. Inequalities in health, however, continue to persist within and between countries despite the cumulative body of evidence characterizing their origins – as defined by geography, ethnicity, gender, socio-economic status and other factors.

While the emphasis has understandably been on characterizing these inequalities between and within population groups, the discourse is now shifting towards building a foundation for structural changes to address a broad array of policies and practices that reduce health inequalities. There is also increased recognition of the importance to further understand how community resiliency and other protective factors, such as cultural continuity in the context of Aboriginal communities or community-led interventions, can contribute to healthy people in healthy communities.

Conference Objectives

- ✦ Provide a forum to critically reflect on our progress and to consider Canada's future role in the reduction of health inequalities in response to the anticipated report of the WHO Commission on Social Determinants of Health.
- ✦ Showcase innovative research, policies and practices that address the social, political, cultural, economic and environmental determinants of health.
- ✦ Profile strategies for building the capacity of population and public health at local, regional, provincial/territorial, pan-Canadian and international levels, and leverage the potential of partnerships and collaboration.
- ✦ Provide a meeting ground for knowledge exchange among public health practitioners, policy-makers, and researchers from a range of disciplines and sectors.

Conference Streams

The following streams are provided as a framework from which to address the conference theme. In contrast to previous conferences, our streams are neither disease- nor issue-specific.

- ✦ **People:** Unevenness in health and disease outcomes defines some populations in Canada as vulnerable. While windows of vulnerability can manifest themselves at different times throughout the life course, those most affected are generally likely to be poor, less educated, and have inadequate living and working conditions.
- ✦ **Places:** The places in which we live, work, play and learn have a profound impact on the health of individuals, communities and populations. Whether urban, rural, regional, provincial/territorial, national or global, these “physical and social environments” are shaped by numerous policies and programs, which can in turn produce unequal access to the resources required for healthy living.
- ✦ **Effecting Systems Change:** Engaging multiple sectors outside of health (e.g., labour, housing, education, environment, finance, agriculture) and facilitating responses across jurisdictions (e.g., regional, provincial/territorial, national, global) are paramount if we are to intervene on the global, political, socio-cultural and environmental forces, which can be attributed to the risk of disease and disability. The pan-Canadian public health landscape is becoming increasingly complex. Our public policy-making enterprise leaves most social, educational and health policies in the purview of several levels of government and sectors with varying levels of human and material resources at their disposal. New public health-oriented collaborations, partnerships, and capacities are required in order to effect systems change and support the multi-level development and implementation of evidence-informed healthy public policies that lead to improvements in overall health status and reductions in health inequalities. Further, intersectoral and whole-of-government initiatives and approaches (e.g., integrated policy development, health impact assessment) must not only be documented but assessed in terms of their effectiveness in reducing health inequalities.

General Information

Simultaneous Interpretation

Simultaneous interpretation will be offered for all plenary sessions and where indicated (identified with this  symbol). Concurrent sessions will be presented in the language of submission. Delegates may attend the concurrent sessions of their choice on a first-come, first-served basis. Headsets will be available to delegates for both simultaneous interpretation and sound quality. Identification will be required to pick up your headset. Please return the headset to the Interpretation Desk at the end of each day.

Registration and Information Desk

The Registration and Information Desk for the Conference is located in the World Trade & Convention Centre. Registration will be available daily, according to the following schedule:

Sunday 1 June	08:00 – 19:00
Monday 2 June	06:30 – 17:00
Tuesday 3 June	08:00 – 16:30
Wednesday 4 June	08:00 – 10:00

Badge Identification

Badges are colour-coded based on registration category and allow admission to all program and social events. Badges must be worn at all times. At the end of the conference, please help us to recycle by dropping your badge off at the Registration Area.

The Daily Newsletter

Three editions of “The Daily” conference newsletter will be available to conference delegates starting on Monday morning with the final edition appearing Wednesday morning. Expanded online coverage will also be available at www.conference.cpha.ca.

Message Centre

Incoming messages for conference delegates will be received at the Registration Desk during registration hours. Messages will be posted on a designated message board. You are encouraged to check the message board frequently throughout the conference. If you are a hotel guest, potential callers should be asked to call the hotel and leave a message in your room.

Adjacent to the Message Centre will be a board designated for postings of employment opportunities. Employers are welcome to post general recruitment notices, job postings, and anticipatory or upcoming staffing notices.

Smoke-free/Scents-free Environment

We are pleased to provide a smoke-free environment. Additionally, for the comfort of all delegates, we ask your cooperation in refraining from wearing scented products while attending the conference.

Cell Phones

All cellular telephones should be turned off upon entering session rooms.

Speakers Ready Room

Room 308, World Trade & Convention Centre

The Speakers Ready Room, located at the World Trade & Convention Centre in Room 308 on the third level, is set aside as a quiet room for reviewing of your presentation material or for any last-minute presentation changes. Speakers are asked to check in with the onsite Presentation Technician. Open daily from 08:00 to 17:00. If you did not submit your presentation in advance, we ask that you allow plenty of time prior to your session for us to complete the uploading process to ensure the integrity of your presentation(s); including fonts, bullets, outlines, animations, etc. The computers will be configured with hardware and software exactly like the computer in the meeting rooms. All presenters are required to submit their presentations no later than 12 hours prior to their presentation time.

Exhibit Area

The Exhibit Area will provide an opportunity to meet and discuss pertinent issues with exhibitors and conference participants. Make sure to visit the Exhibit Area and enhance your personal network of contacts. The Exhibit Area is located in Room 200.

Cyber Café

To access email while in Halifax, a Cyber Café is available near the Registration Desk in the World Trade & Convention Centre. In consideration of others, we request that delegates limit their time to 5-10 minutes.

Accreditation



Canadian College of
Health Service Executives
Collège canadien des
directeurs de services de santé

Attendance at this
program entitles certified
Canadian College of
Health Service Executives

members (CHE/FCCHSE) to **14.25 Category II credits** toward their maintenance of certification requirement.

This event is an accredited group learning activity (Section 1) as defined by the Maintenance of Certification program of the Royal College of Physicians and Surgeons of Canada, and approved by Queen's University (maximum number of hours – 14.25).

To obtain accreditation, participants must submit a Certificate of Completion to the appropriate accrediting body. The Certificate of Completion can be obtained by contacting the Conference Department at conference@cpha.ca.

Students' Corner



CPHA and its partners are committed to building capacity among the next generation of public health leaders. This year's conference will again feature several events aimed at students and trainees with an interest in public health research, policy and practice. Look for the special icon  in the program to highlight presentations that are being given by public health students or that have been specially planned to appeal to students and trainees.

Population and Public Health Student Awards/Dr. John Hastings CPHA Student Award

The purpose of these awards is to recognize excellence in the next generation of population and public health researchers, policy-makers and practitioners. There are three categories:

- ✦ Dr. John Hastings CPHA Student Award
- ✦ Population & Public Health Student Awards – Masters Level
- ✦ Population & Public Health Student Awards – PhD Level

The Dr. John Hastings CPHA Student Award will be presented to one successful PhD student for the best abstract as determined by the CPHA Awards Committee based on the recommendation of the Steering Committee. Travel, accommodation and registration fees will be covered by CPHA up to a maximum of \$1,500. The successful applicant will also receive a 1-year CPHA membership and a \$1,000 bursary.

The Population & Public Health Student Awards (Masters/PhD) will provide up to four awards (two at the Masters level and two at the PhD level) to the successful student applicant(s). The value of each award will be \$300 (for Masters level students) and \$500 (for PhD level students). Travel, accommodation and registration fees incurred by successful applicants who attend the CPHA Conference will be covered by the partnering organizations, up to a maximum of \$1,500. Population and public health research involves research with a goal to improve the health of populations in Canada and globally, achieved through a better understanding of: the interactions between social, cultural, economic, environmental and occupational factors that determine human health and development; the population- and community-level policy and program interventions that improve the health of populations. Successful submissions to the Population and Public Health Student Awards/Dr. John Hastings CPHA Student Award will be published in a future issue of the *Canadian Journal of Public Health*.

CPHA Student Breakfast

The CPHA and its partners are committed to engaging the next generation of public health leaders. If you are a current student member of CPHA or would like to become one, you are invited to this exciting breakfast event! The breakfast will be co-hosted by public health leaders from the Canadian Public Health Association, the Canadian Institutes of Health Research-Institute of Population and Public Health, the Canadian Institute for Health Information – Canadian Population Health Initiative, and the Public Health Agency of Canada. As a student, you will get the unique opportunity to discuss the future of public health in Canada with some of the great champions in the field.

Travel Bursaries

This year, we will provide a limited number of Student Travel Bursaries to full-time students whose abstracts have been reviewed and accepted into the program. The conference currently provides a discounted registration rate to full-time students. Student winners of the 2008 Student Award Program/Dr. John Hastings CPHA Student Award are not eligible for the Student Travel Bursary.

Student Travel Bursary for Excellence in Rural and Remote Health Research

This year, the Atlantic RURAL Centre, a collaborative research network and resource centre based in Atlantic Canada, is pleased to offer a travel bursary to the best graduate student abstract addressing dimensions of physical and social environmental factors affecting health of rural and remote Canadians.

Program at a Glance

Sunday 1 June 2008

Registration	08:00-19:00
Pre-conference Sessions.....	09:00-18:00
Opening Ceremony 🗣️	19:00-19:30
Plenary I 🗣️	19:30-20:30
Welcome Reception.....	20:30-22:30

Monday 2 June 2008

Registration	07:00-17:00
Plenary II 🗣️	09:00-10:00
Refreshment Break.....	10:00-10:30
Exhibit Program.....	10:00-17:30
Concurrent Sessions	10:30-12:00
Awards Luncheon 🗣️	12:00-14:00
Concurrent Sessions	14:15-15:45
Wine and Cheese Reception with Poster Presenters and the Exhibitors.....	15:45-17:30
Fun Night at Pier 21	18:00-22:00

Tuesday 3 June 2008

University of Toronto Public Health Sciences Alumni Association Breakfast	07:00-08:00
Dalhousie University, Dept. of Community Health & Epidemiology Breakfast	07:00-08:00
Prevention of Violence Canada – Town Hall Meeting and Breakfast.....	07:00-08:30
Registration	08:00-16:30
Plenary III 🗣️	08:30-10:00
Refreshment Break.....	10:00-10:30
Exhibit Program.....	10:00-15:00
Concurrent Sessions	10:30-12:00
Lunch (Free Time).....	12:00-13:00
Plenary IV 🗣️	13:00-14:30
Refreshment Break.....	14:30-15:00
Concurrent Sessions	15:00-16:30
CPHA Annual General Meeting	16:30-18:30
Public Forum	19:00-21:00

Wednesday 4 June 2008

CPHA Student Breakfast 🇨🇦	07:00-08:00
Immunization Hot Topics – Breakfast	07:00-08:00
Registration	08:00-10:00
Concurrent Sessions	08:30-10:00
Refreshment Break.....	10:00-10:30
Plenary V 🗣️	10:30-12:00
Closing Ceremony	12:00-12:15

🗣️ *Simultaneous Interpretation available*

🇨🇦 *presentations that are being given by public health students or that appeal to students and trainees.*



Conference Program

Sunday 1 June 2008

08:00 – 19:00	Registration	Level 1, WTCC
08:00-16:00	Know When to Hold 'em; Know When to Fold 'em, Making a Difference for Health: Community Medicine Specialists' and Public Health Physicians' Role in Policy Part II of the <i>National Specialty Society for Community Medicine</i> public health policy session. This accredited session will present theory, discussion and small group work to enable participants to learn through case studies. The session will demonstrate challenges and opportunities at all levels of government and will achieve the following objectives: <ul style="list-style-type: none">• Deepen the understanding of frameworks for public health policy analysis;• Identify challenges and obstacles faced by public health physicians when developing and/or implementing public health policy;• Learn more about a specific public policy issue of current interest to community medicine physicians;• Identify action for future continuing professional development opportunities on public policy analysis. Lunch will be provided. Pre-registration and a registration fee required.	Suite 301, WTCC
08:00-12:00	Public Health Network Workshop objectives: <ul style="list-style-type: none">• To provide information about the Public Health Network;• To engage delegates in discussion about the work of the Public Health Network; and• To invite delegates to share other relevant projects and programs, successes and challenges, lessons learned, and potential next steps.	Suite 302, WTCC
08:00-12:00	Environmental Sustainability and Impacts on Health: What is the Feasibility and What are the Issues towards Building a National Agenda? At the September 2007 Canadian Public Health Association conference, the Suzuki Foundation officially launched the <i>Prescription for a Healthy Canada: Towards a National Environmental Health Strategy</i> . This document champions the idea of building an overall environment and health framework that would feature coordinated, effective and timely strategic development involving multiple partners. The National Collaborating Centre for Environmental Health and CPHA are interested in fostering further discussion about this concept and wish to hear from interested participants about the underlying issues and key priorities. The purpose of this pre-conference half-day workshop is to launch this dialogue. This session will combine presentations from leaders in the field of environmental health with opportunities for facilitated dialogue. <i>National Collaborating Centre for Environmental Health and the Canadian Public Health Association</i>	Suite 204, WTCC
08:00-12:00	Linking Three National Resources to Support Local Practice: A CDP Best Practice Case Study This workshop will focus on supports available to the uptake of best practices by practitioners. The Public Health Agency of Canada's (PHAC) Office of Public Health Practice and the Centre for Chronic Disease Prevention and Control, in collaboration with the National Collaborating Centre for Methods and Tools (NCCMT), will jointly showcase some of the interventions profiled in the upcoming Chief Public Health Officer of Canada's first annual report on the state of public health in Canada. For some interventions, significant evidence exists regarding their demonstrated effectiveness and value ("best practices"); while others have been identified as promising according to the new Levels of Evidence Classification System released by the Canadian Best Practices Initiative in 2008. <i>Public Health Agency of Canada's Office of Public Health Practice and the Centre for Chronic Disease Prevention and Control, in collaboration with the National Collaborating Centre for Methods and Tools</i>	Suite 205, WTCC

Pre-Conference Sessions

08:30-12:00	Addressing the Second-Tier Health Status of First Peoples: The Social Determinants and Structural Underpinnings of Indigenous Well-being in Canada This workshop provides an overview of the most current research concerning Indigenous health in Canada, including: Aboriginal-specific social determinants of health (e.g., colonization and cultural dispossession); the translation of health research and knowledge into useful community practices and deliverables; the social and geographic contexts of Aboriginal health status; and the interface between Aboriginal peoples and health systems in Canada. <i>National Collaborating Centre for Aboriginal Health</i>	Suite 203, WTCC
09:00-17:00	Understanding the Relationship between Health Inequities and Child and Youth Injury Prevention This workshop will increase awareness around the issues of preventing child and youth injury, particularly as they relate to health inequities. The day will be divided into a number of sessions that will look at the leading causes of death and injury for children and youth – motor vehicle-related injury and falls. <i>Atlantic Collaborative for Injury Prevention (ACIP) (formerly the Atlantic Network for Injury Prevention)</i>	Suite 101, WTCC
09:00-17:00	Social Determinants of Health: Knowledge into Practice In 2005, the World Health Organization established the Commission on Social Determinants of Health, supported by nine knowledge networks (KNs). Three of the KNs were financially supported by the Government of Canada and Canadian researchers were actively involved with several others, which collectively represented an unprecedented knowledge gathering and synthesis initiative. Although the formal work of the KNs has all but ended and most of their reports have been published on the Commission's web site at http://www.who.int/social_determinants/knowledge_networks/final_reports/en/index.html , a unique opportunity exists to use the expertise of the KNs as a resource for Canadian public health practice, intersectoral action and policy innovation. This daylong session will provide opportunities for lively interaction with leaders of a number of knowledge networks. <i>The workshop is supported in part by a grant from the Canadian Institutes of Health Research program on Research Development and Knowledge Exchange in Population Health, and is presented in partnership with the National Collaborating Centre for Determinants of Health, the Public Health Agency of Canada, and the Canadian Population Health Initiative.</i>	Room 100, WTCC
09:00-17:00	The 9th Annual Canadian Field Epidemiology Program (CFEP): Surveillance Evaluation Workshop: Data for Action This workshop is interactive, moderated by experts in the field and is accredited by the Royal College of Physicians and Surgeons of Canada (Section 1 MCOMP credits). This event attracts a large number (50-100) of public health professionals from a variety of backgrounds including physicians, veterinarians, and nurses, among others. The scope of the evaluations is very wide. Field epidemiologists systematically review local, regional, provincial and national surveillance systems, addressing chronic and infectious conditions, with interest in longstanding diseases such as influenza, as well as new and emerging infections. For 2008, the topic areas include surveillance of adverse events following immunization, nosocomial MRSA, syphilis, and <i>Cryptococcus gattii</i> , among others. The workshop includes two plenary speakers who will discuss the use of surveillance data for effective public health action. Each evaluation will be followed by discussion and critique, moderated by national experts in each topic area. <i>Canadian Field Epidemiology Program, Office of Public Health Practice, Public Health Agency of Canada</i>	Suite 304, WTCC

Pre-Conference Sessions



13:00-17:00 **Sharing Research: Preparing to Publish** **Suite 306, WTCC**
This workshop is the third in a series offered at the CPHA conference for students and new public health researchers. The objective for this session is to provide attendees an opportunity to explore the writing process for peer-reviewed publications. The workshop will be conducted in two parts: first, a presentation on the writing process itself and second, a panel discussion on reviewing and editing for publication.
CIHR-Institute of Population and Public Health

13:00-17:00 **IPPH - Centres for Development Program** **Suite 202, WTCC**
The CIHR-Institute of Population and Public Health supports the Centres for Research Development Program, including seven centres, which have received infrastructure support to understand and address the impacts of physical and social environments (or places such as workplaces, schools, communities) on the health of communities and populations. Centres are jointly co-governed by researchers and research users (e.g., policy makers, practitioners from government and non-governmental sectors) in an effort to maximize the effective application and use of knowledge into policies, programs and practices to improve population health and reduce inequalities. This half-day symposium will feature lessons learned to date gleaned from the Centres' innovative research and knowledge translation programs. Several of the Centres are addressing the impact of urban and rural places, as well as neighbourhood effects on the health of vulnerable populations. The focus is not only on understanding what determines the influences of factors that shape the places in which we live, play, work and learn but on improving the effectiveness and cost-effectiveness of policy and program interventions which shape them.
CIHR- Institute of Population and Public Health

13:00-17:00 **National Collaborating Centres for Public Health and Their Work on Social Inequality** **Suite 203, WTCC**
KSTE (knowledge synthesis, translation and exchange) in Action: The National Collaborating Centres for Public Health Models for Effecting Systems Change
This workshop will provide participants with models and tools for effecting systems change as each NCC will provide an overview of public health KSTE activities undertaken. Each NCC will identify practical examples, share lessons learned and success to date from doing KSTE in action as it relates to their area of focus, stakeholder/user groups and the determinants of health.
National Collaborating Centres for Public Health

Reduce ■ *Renew* ■ *Sustain*



In an effort to reduce our impact on the environment, this year's delegate bag was fabricated using 51% post-consumer recycled materials, including water bottles and yogurt containers. Perfect for trips to the grocery store, we hope that you will find this bag functional, reusable and friendly to the environment.

Pre-Conference Sessions

13:00-17:00	Towards the Development of a National Set of Indicators of Health Inequalities	Suite 205, WTCC
	<p>Reducing health inequalities is a key area of focus for the Population Health Promotion Expert Group (PHPEG) of the Pan-Canadian Public Health Network (PHN). The PHN Council has asked the PHPEG to develop pan-Canadian indicators that measure the level of health inequalities in Canada and the reduction of same. This session aims to review and advance the work carried out to date by the PHPEG and others actively pursuing the development of national level indicators. The program would include:</p> <ul style="list-style-type: none">• Large group work: to review and discuss reports and results from PHPEG and related initiatives undertaken to date.<ul style="list-style-type: none">– In October 2006, the PHPEG hosted a workshop with an overarching objective to develop indicators of health inequalities. Three categories were identified: indicators of inequalities in health, indicators of inequalities in the determinants of health, and – the most challenging – indicators of the impact of health inequalities. In 2007-08, the PHPEG is involved in a project to establish a common set of indicators of health inequalities, and the preparation of a literature review on methodologies used in studies on the health and other social costs of poverty.– In November 2007, the Office of Public Health Practice, PHAC, co-sponsored with the Urban Public Health Network a workshop designed to engage participants in a discussion about current and future work on public health indicators in Canada that would be meaningful at a local level, including indicators of inequality.• Small group “workshops”: to consider which indicators are most useful and important and develop a list of the top 10 or 20 indicators.<ul style="list-style-type: none">– Reporting back and general discussion of next steps/where do we go from here.	

Population Health Promotion Expert Group and the Pan-Canadian Public Health Network

13:00-15:00	Early Detection and Response Course: Working Together for More Effective Infectious Disease Detection and Response	Suite 305, WTCC
	<p>This workshop will explore opportunities for effective communication and collaboration between the public health and clinical care sectors. It will present a new continuing education course that is designed to equip frontline clinicians with practical information and tools to respond to infectious disease outbreaks, such as an influenza pandemic, while fostering collaboration between public health, clinical care, and laboratories.</p>	

Canadian Public Health Association in collaboration with the Public Health Agency of Canada

13:00-17:00	Recent Developments in Health Literacy in Canada	Suite 204, WTCC
	<p>This session will present highlights from two new reports: <i>A Vision for a Health Literate Canada</i> by CPHA's Expert Panel on Health Literacy; and <i>Health Literacy in Canada: A Healthy Understanding</i> by the Canadian Council on Learning. Promising practices from across the country will also be presented for discussion.</p>	

Refreshments will be served, compliments of Canadian Council on Learning

Canadian Public Health Association, Canadian Council on Learning, Health and Learning Knowledge Centre

16:00-18:00	The National Specialty Society for Community Medicine Annual General Meeting	Suite 301, WTCC
	<p>National Specialty Society for Community Medicine Annual General Meeting is open to all NSSCM members. Separate pre-registration required.</p>	

Sunday 1 June 2008



19:00 – 19:30

Opening Ceremony 🇨🇦

Halifax Metro Centre

Bagpiper: David Allison, Eastern Health, NL

Moderator: Ron de Burger, Chair, CPHA

Greetings: David Butler-Jones, Chief Public Health Officer, PHAC
John Frank, Scientific Director, CIHR-IPPH
Cordell Neudorf, Chair, CPHI Council, CIHI
Hope Beanlands, Scientific Director, National Collaborating Centre for Determinants of Health
Marie McCully Collier, President, PHANS

19:30 – 20:30

Plenary I 🇨🇦

Halifax Metro Centre

WHO Commission on Social Determinants of Health

Sir Michael Marmot, Chair of the World Health Organization (WHO) Commission on Social Determinants of Health, will address the conference regarding the global imperative to address health inequities within and between countries, and the related work and key findings of the WHO Commission. His discussion will set the stage for the imminent release of the Commission's final report and discuss implications for countries and global institutions.

Speaker

🇨🇦 Sir Michael Marmot, Chair
World Health Organization Commission on Social Determinants of Health

Moderator

🇨🇦 Ron de Burger, Chair, CPHA



20:30 – 22:30

Welcome Reception

Room 200, WTCC

A great opportunity to meet new friends and get re-acquainted with colleagues from across the country.

Sponsored by sanofi pasteur.

Eco-friendly Options

The World Trade & Convention Centre (WTCC) is pleased to advise visitors of the steps we are taking to become more environmentally responsible. Our Solid Waste Management Program conforms with the HRM Solid Waste Resource collection and disposal By-Law no. 600. The WTCC also provides appropriate waste separation containers in public areas to encourage visitors to separate waste into regular refuse, organic waste, paper and blue bag recyclables. Other WTCC eco-friendly operations include:

- A state-of-the-art system to control ventilation and temperatures;
- Increased outdoor air intakes
- An environmental policy for the purchase of products and equipment
- A hazardous waste intervention program
- Cleaning products, when available, are to be either EcoLogo or Green Seal certified
- Efficient water management, including electronic equipment to reduce water consumption
- A choice of menus with local and organic products; and trans-fat free menus
- Food service in porcelain dishware
- Energy-efficient lighting and mercury-free light bulbs

Monday 2 June 2008

08:00 – 17:00 **Registration** **Level 1, WTCC**

08:30 – 09:00 **Welcome** **Halifax Metro Centre**

- ✦ Debra Lynkowski, Conference Co-Chair; Chief Executive Officer, CPHA
- ✦ Erica Di Ruggiero, Conference Co-Chair; Associate Director, CIHR-IPPH

09:00 – 10:00 **Plenary II** **Halifax Metro Centre**



Canadian Commentary on Reducing Health Inequalities

This interactive panel will feature Canadian perspectives on how Canada can be poised to reduce inequalities through research, policy and community action.

Speakers

- ✦ David Butler-Jones, Chief Public Health Officer, Public Health Agency of Canada
– *Public health system perspective*
- ✦ Margo Greenwood, National Collaborating Centre for Aboriginal Health
– *Indigenous perspective*
- ✦ John Frank, Scientific Director, CIHR-Institute of Population and Public Health
– *Research perspective*



Moderator

- ✦ Sharon Manson Singer, President, Canadian Policy Research Networks



10:00 – 10:30 **Refreshment Break** **Room 200, WTCC**

Sponsored by the Nova Scotia Health Research Foundation

10:00 – 17:30 **Exhibits & Poster Presentations** **Room 200, WTCC**

Delegates are encouraged to visit the exhibits and posters to see the latest products and publications relating to all facets of public health and to learn more about the work being carried out by conference partners, the private sector, government departments, agencies and non-governmental organizations.

10:30 – 12:00 **Thematic Sessions** **Suite 301, WTCC**

Intersectoral Action and Health: Global Learnings

Although collaborative action across government departments and sectors to improve health and social equity is recognized as essential by numerous players related to health, little is written about appropriate conditions, garnering support, or key methods, tools, and approaches that can be used. Through a global literature review, a cross-country dialogue, the commissioning of 20 case studies, and a paper that surfaces promising learnings from different country contexts, the Public Health Agency of Canada and the World Health Organization have attempted to address some of these knowledge gaps. This session will highlight key findings from this work, and will invite case study authors to share their experiences in order to illustrate these learnings.

Speakers

- ✦ Jim Ball, Director General, Strategic Initiatives and Innovations Directorate, PHAC
- ✦ Jan Sanderson, Executive Director, Healthy Child Manitoba Office; Secretary to the Healthy Child Committee of Cabinet
- ✦ J. De Maeseneer, Department of Family Medicine and Primary Health Care, Ghent University
- ✦ Patricia Frenz, Social Determinants of Health Initiative, Division of Health Planning, Ministry of Health, Chile

Moderator

- ✦ Heather Fraser, Manager, Health Determinants/Global Initiatives Division, PHAC

Monday 2 June 2008



HPV Vaccine Out of the Box

Suite 302, WTCC

In the fall of 2007, some jurisdictions implemented new HPV immunization programs with very little time to prepare. At the same time, negative media coverage was generating suspicion of this new vaccine, increasing pressure on already strained public health personnel and resources. This session will examine how three jurisdictions handled the challenge of this new program, the lessons learned, and the research that will benefit future programs. A panel discussion will then focus on recommendations and evaluation for current and future programs as more jurisdictions plan to launch HPV programs in the fall of 2008.

Speakers

- ✿ Jocelyn Downie, Canada Research Chair, Health Law and Policy, Dalhousie Law School
- ✿ Ian Gemmill, Medical Officer of Health, Kingston, Frontenac and Lennox & Addington Public Health
- ✿ Cathy O'Keefe, Director, Disease Control, Public Health, Department of Health and Community Services

Moderator

- ✿ David J. Allison, Medical Officer of Health, Eastern Health

Health Literacy: Reducing Social and Health Inequities

Suite 303, WTCC

This session will explore why health literacy matters in public health. Leading research from the Harvard School of Public Health will situate the issue within a social determinants of health framework, followed by a presentation of recent findings on the distribution of health literacy in Canada. The Skilled for Health program, currently being implemented in England, represents one new approach to reducing disparities in literacy and health at the national level. Finally, taking action on health literacy in Canada will be discussed.

Speakers

- ✿ Rima Rudd, Department of Society, Human Development & Health, Harvard School of Public Health – *Why Does Health Literacy Matter? A Global Perspective*
- ✿ Irving Rootman, Co-Chair, CPHA Expert Panel on Health Literacy – *Distribution of Health Literacy in Canada: The Canadian Perspective*
- ✿ Rachel Wells, Head of Health Literacy, Department of Health, England – *An Innovative National Approach to Health Literacy: The English Perspective*
- ✿ Debra Lynkowski, Chief Executive Officer, CPHA – *Moving Forward in Canada*

Moderator

- ✿ Sue Sullivan, Project Manager, CPHA

10:30 – 12:00

Oral Abstract Presentations

Examining the Social Determinants of Health - I

Suite 201, WTCC

- Public Health: The Need for a New Ethic – *Nuala Kenny*
- The Role of Public Health in Addressing Mental Health and Social Inequities – *Steve Jreige*
- Public Health Renewal in Nova Scotia – *Robert Strang*
- Developing Scenarios in Public Health – *Jan Trumble Waddell*
- Negotiating Dementia Home Care: A Critical Analysis – *Catherine Ward-Griffin*

Determinants of Overweight and Obesity

Suite 202, WTCC

- Food Price Interventions to Address Socio-economic Determinants and Disparities in Obesity Prevention – *Barbara von Tigerstrom*
- Overweight and Obesity in Urban Canada: Towards a Better Understanding of the Socio-environmental Determinants – *Susan J. Elliott*
- Maternal Weight and the Obesogenic Environment in Nova Scotia – *Sara Kirk*
- Policy Recommendations for Controlling the Impact of Marketing on Children – *Bonnie Hostrawser*
- The Geography of Overweight in Québec – *Alexandre Lebel* 🇨🇦

Monday 2 June 2008

Women at Risk

Suite 203, WTCC

- Reducing Health Inequities for Aboriginal Women Leaving Intimate Partner Violence – *Victoria Smye*
- The Effects of Past Intimate Partner Violence and Current Resources on Women's Health after Leaving an Abusive Partner – *Marilyn Ford-Gilboe*
- Team Spirit: Taking Action on Physical Inactivity Among Aboriginal Girls – *Sydney Millar*

New Technologies and Tools in Public Health

Suite 204, WTCC

- Community Health Informatics: An Introduction, Demonstration, and Overview – *Keith Wilson*
- Benefits and Challenges of New Technologies for Expanding Communication Capabilities – *Gwen Williams*
- Skills Online: Building Practitioner Competence in an Inter-professional, Virtual Classroom – *Jennifer Lowe*
- Using a Canadian Online Public Health Professional Development Program in the Caribbean – *Hilary Robinson*
- Health Promoters in Canada: Developing Discipline-specific Competencies – *Marco Ghassemi*

Health Literacy

Suite 304, WTCC

- Health and Learning: Experiences of Adults with Literacy Challenges and Immigrants & Refugees – *Hélène Grégoire*
- A Pilot-test of the Effectiveness of Spanish Health Skills Literacy and Health Knowledge Videos on Health Literacy and Related Outcomes – *Iraj Poureslami*
- The Read to Me! Uptake Study – *Cyndi Brannen*
- Informing Practice with Research: Read to Me! Uptake Study – *Chrystal Coates*
- What's Culture Got To Do With It? Health Literacy in Ethnocultural Communities in Greater Vancouver Area, BC – *Iraj Poureslami*

Poverty, Income and Health

Suite 305, WTCC

- Socio-economic Inequalities in Child Physical Health: What Have We Learned from the Quebec Longitudinal Study of Child Development (QLSCD)? – *Louise Séguin*
- Children, Poverty and Health Care Utilization: Research and Implications – *Ted McNeill*
- Antibiotic Prescriptions for Children in Manitoba: The Changing Socio-economic Gradient – *Marni Brownell*
- Does Province of Residence Matter to the Health of Canadians in the Lowest Income Category? – *Raymond Fang*
- Examining the Income Gradient in Health-related Quality of Life in Canada – *Cameron McIntosh*

Aboriginal Peoples' Health: Research Methodology - I

Suite 306, WTCC

- Broader Determinants of Health in an Aboriginal Context – *Steven Vanloffeld*
- Aboriginal Health Human Resources: More Than a Simple Determinant of Health – *Emily Lecompte* 🇨🇦
- Telling Our Stories: Quantifying, Documenting and Articulating First Nations' Health Needs – *Sharon Paul-Rudderham*
- Network Environments for Aboriginal Research British Columbia: The Development, Evolution and Future Direction of a Health Research Network – *Jeff Reading*
- Métis Ethics and Research Methods – *Tricia Logan*

Homeless and Street Health

Suite 101, WTCC

- Building Community Health Capacity through the Development of an Online Community of Practice for Street/Outreach Nurses in Ontario – *Ruta Valaitis*
- Being Sick On and Off the Street: Homeless Youth and Their Health – *Jeff Karabanow*
- The Processes and Structures Supporting the Integration of Health and Social Services Targeting Persons Who Are Homeless – *Manal Guirguis-Younger*
- Resilience: An Organizing Theme for Matters that Matter – *Leah Levac* 🇨🇦
- It Takes a Whole Community to Engage Street Clients – *Jan Appleton*

Monday 2 June 2008



10:30 – 12:00 Workshops

Measuring Obesity

Margot Shields, Mark Tremblay

Suite 205, WTCC

**Health Inequalities and Systematic Reviews:
A Tool for Review Authors**

Erin Morris

Room 100, WTCC

12:00 – 14:00

CPHA Awards Luncheon

Halifax Metro Centre

Each year at its Annual Conference, CPHA honours those who have contributed significantly to public health in Canada through the CPHA Honorary Awards Program.

The following awards will be presented:

- R. D. Defries Award
- Certificate of Merit
- Honorary Life Membership
- Ron Draper Health Promotion Award

Student Awards 🇨🇦

- Dr. John Hastings Student Award
- Masters: Population and Public Health Student Awards*
- PhD: Population and Public Health Student Awards*

* Jointly sponsored by CPHA, CIHI-CPHI, CIHR-IPPH and PHAC

Student Travel Bursary Award Winners

PHAC/CPHA Public Health Human Resources Awards

Chairperson: Ingrid Tyler, Director, CPHA Board 🇨🇦

14:15 – 15:45

Thematic Sessions

**Primary Health Care Reform in the Balkans and the Contribution
of Civil Society to Improve Access for Vulnerable Populations**

Suite 301, WTCC

Equitable access to health for all in Bosnia & Herzegovina (BiH) and Serbia presents a challenge to all sectors. Significant progress is being made in terms of reforming the health system infrastructure, but the socio-economic and political transformation taking place is not without health consequences. The presenters will share lessons learned in BiH and Serbia and discuss contributions made by Canada in primary health care policy, youth health, and public health association strengthening.

Speakers

- 🇨🇦 Safet Omerovic, Minister of Health, Federation of Bosnia and Herzegovina
- 🇨🇦 Ranko Skrbic, Minister of Health and Welfare, Republika Srpska, Bosnia and Herzegovina
- 🇨🇦 Ivana Mistic, Assistant Minister of Health, Republic of Serbia
- 🇨🇦 Snezana Samardzic-Markovic, Minister of Youth and Sport, Republic of Serbia

Moderator

- 🇨🇦 James Chauvin, Director, Global Health Programs, Canadian Public Health Association
- 🇨🇦 Janet Hatcher Roberts, Executive Director, Canadian Society for International Health

Monday 2 June 2008

Gender

Suite 302, WTCC

Gender is a known determinant of health and often intersects with multiple social and biological determinants. For example, women have greater morbidity related to poor mental health which may in turn affect issues of employment, housing and social welfare. We also know that far more young men die due to preventable workplace accidents and injuries. It is therefore important to understand the relationship between gender and health within the context of larger social policies. This session will provide an overview of some of the current research and policy issues concerning gender with a focus on employment, including an investigation of how economic policies, including labour policies and labour norms, differentially affect the health of women and men.

Speakers

- ✿ Jan Angus, Associate Professor, Lawrence S. Bloomberg Faculty of Nursing, University of Toronto
- ✿ Barbara Clow, Executive Director, Atlantic Centre of Excellence for Women's Health
- ✿ Blye W. Frank, Professor and Head, Division of Medical Education, Dalhousie University

Moderator

- ✿ Joy Johnson, Scientific Director, CIHR-Institute of Gender and Health

Employment

Suite 303, WTCC

The relationship between employment and health inequalities in terms of its political, gender, economic and socio-cultural impacts merits careful attention. Labour markets, workplace policies and other macro- and micro-level actions shape employment opportunities and conditions and the resulting inequalities. The causal pathways underlying the ubiquitous gradient in health status with respect to income are, however, not well understood. One pair of hypotheses is that, on the one hand, it is driven primarily by what income can buy; and on the other that income serves more as a marker. In other words, income reflects features of an individual's participation and hierarchical roles in society, which is proxied better by their labour market activity and income from paid work. Drawing on a newly completed and precedent-setting 10-year mortality follow-up of the 1991 census by Statistics Canada, analyses to determine whether the correlation between income and mortality is stronger using wages and salaries as the independent variable, or some measure of total income will be presented. Questions such as the extent to which occupation represents some sort of sociological ranking of status will also be covered. The relationship between gender, work and health in different contexts will be interrogated. Employment conditions have differential effects on a variety of population groups. The role of gender in shaping labour force participation and interacting with working conditions must therefore also be examined. This session will feature two presentations followed by an interactive dialogue.

Speakers

- ✿ Michael Wolfson, Assistant Chief Statistician, Analysis and Development, Statistics Canada
- ✿ Barbara Neis, Professor of Sociology, Memorial University of Newfoundland & Labrador

Moderator

- ✿ John Frank, Scientific Director, CIHR-IPPH

14:15 – 15:45

Oral Abstract Presentations

Using Research to Improve Health

Suite 201, WTCC

- Can This Research Be Useful in My Community? – *Donna Ciliska*
- Research Results Adaptation: An Exploratory Study Among Canadian Health Researchers – *Jalila Jbilou* 🇩🇪
- An Exploration of Knowledge Translation in the Context of an Aboriginal Health Research Network – *Elizabeth Estey* 🇩🇪
- Les pratiques réflexives dans la recherche participative en santé publique – *Yan Senechal*
- Is Our Scientific Culture an Impediment to the Health of Canadians? – *Roy Cameron*

Monday 2 June 2008



Environments, Neighbourhoods and Health

Suite 202, WTCC

- WHY ADAPT? A Critical Analysis of Climate Change Adaptation Options for Public Health in Canada – *Mark Pajot* 🇨🇦
- An Example of How the Environment Contributes to Health Disparities: Estimating Mortality That Could Be Prevented if Interior and Northern British Columbia Had the Same Air Quality as Vancouver – *Catherine Elliott* 🇨🇦
- Contextualizing: One Neighbourhood at a Time to Enable Structural Changes – *Andrea Chircop* 🇨🇦
- A Comparative Analysis of Bayesian and non-Bayesian Disease Mapping Approaches in Assessment of Deprivation and Mortality Risk in Nova Scotia – *Mikiko Terashima* 🇨🇦
- Health, Well-being and Inequities in Two Nova Scotia Communities – *Michael Pennock*

International Health Issues

Suite 203, WTCC

- A Comprehensive Approach to International Public Health at the Public Health Agency of Canada – *Garry Aslanyan*
- Learning from Other Cultures: Gross National Happiness as a Framework for Health Impact Assessment – *Michael Pennock*
- Is the Path to Human Well-being Inevitably Unsustainable? Some Observations from Global- and National-level Analyses – *Daniel Rainham* 🇨🇦
- Méthode Bamboo : mécanisme d'intégration, de collaboration et de renforcement des capacités entre les milieux politique, communautaire et académique dans cinq villes de Pernambuco- Brésil – *Ronice Maria Franco de Sá*
- International Collaboration: Establishing Core Global Curriculum and Student Exchange for Health Promotion & Education – *Marcia Hills*

Addressing Addictions

Suite 204, WTCC

- Public Health Agency of Canada's Fetal Alcohol Spectrum Disorder Initiative: Building Capacity, Evidence and Collaboration Across Jurisdictions, Professions and the Country to Effect System Change – *Mary Johnston*
- Physicians' Attitudes to Methadone Maintenance Treatment in Nova Scotia – *Jessica Dooley* 🇨🇦
- Social Relationships and Harm Reduction Practice Among Injection Drug Users in Nova Scotia – *Joanne Parker* 🇨🇦
- Reducing Health Inequities Regarding Aboriginal Access to Culturally Safe and Effective Mental Health and Addictions Services: A Critical Cultural Approach to Harm Reduction – *Victoria Smye*
- Development of Community-based Networks to Address the Life Span Needs of Individuals with Fetal Alcohol Spectrum Disorder and Their Caregivers – *Denise Milne* 🇨🇦

Rural Health

Suite 304, WTCC

- Homelessness and Health: Developing Effective Public Health Interventions in Northern Communities – *Carol Kauppi*
- The Food Self-sufficiency Gradient of Farm Families in Three Canadian Provinces – *Lynn McIntyre*
- 'I Know What's Gone Into It': Farm Women's Conceptualization of Food Safety in Three Canadian Provinces – *Krista Rondeau* 🇨🇦
- Where We Live: Retaining Physicians in Rural Communities in Alberta – *Pamela Cameron* 🇨🇦
- Burying Traditions, Not Children: Keeping Kids Safe in Agricultural Environments – *Pamela Fuselli*

Infectious Disease and Emergency Response

Suite 305, WTCC

- Estimating the Infection Rate of West Nile Virus (WNV) in Alberta: Results from Two Seroprevalence Surveys – *Tricia Prodaniuk*
- Knowledge, Attitudes and Beliefs of Older Canadians and Their Healthcare Providers Regarding Shingles and Shingles Vaccine – *David Shaw* 🇨🇦
- Overview and Critique of Public Health Emergency Laws in Canada – *Elaine Gibson*
- Making the Connection: The CAPC/CPNP Approach to Working with Vulnerable Populations and Emergency Preparedness and Response – *Ann Robertson*
- Development of a Program to Promote the Use of Appropriate Vaccinations in Post-splenectomy Patients – *Kathryn Slayter*

Monday 2 June 2008

Changing Systems to Reduce Gaps in Health

Suite 306, WTCC

- Developing an Alternative Framework for Community Health Promotion Effectiveness: Towards a Dynamics for Change Approach – *Marcia Hills*
- Reducing Health Inequalities: How to Effect Systems Change and What is the Evidence Which Policies Work? – *Jordan Panayotov*
- Health Promotion Research Centres: Their Role in Supporting Evidence-informed Health Systems Change – *Sandra Crowell*
- Primer to Action: Shifting the Dialogue on Social Determinants of Health and Chronic Disease Prevention – *Connie Clement*
- Using Health Status Reports to Effect Systems Change in RHA's – *Cordell Neudorf*

Advocacy in Health

Suite 101, WTCC

- Bringing Health to Poverty: Actions for Health Providers – *Laura Hanson*
- Advocacy in Regionalized Health Care: A BC Collaboration – *Nelson Ames*
- Supporting Organizations in the Pursuit of Equity and Social Justice – *Colleen Davison*
- Effective Alcohol Policy and Advocacy: Current Strategies and Emerging Opportunities – *Denise De Pape*

14:15 – 15:45

Workshops

The Food Security Policy Lens: Understanding the Relationship Between Public Policy and Food Security in Nova Scotia
Lynn Langille

Suite 205, WTCC

The Cost and Affordability of a Basic Nutritious Diet in Nova Scotia: Implications for Policy
Lesley Frank

Health Inequities in Canada: Next Steps in Addressing the Social Determinants of Health
Heather Fraser

Room 100, WTCC

15:45 – 17:30

Wine & Cheese Reception with Posters & Exhibits

Room 200, WTCC

An informal wine and cheese reception with our poster abstract presenters and exhibitors.

18:00

Ceilidh at Pier 21
CPHA Fun Night 2008

Pier 21

Join in the Ceilidh, where a hearty mix of Nova Scotia music and maritime food come alive at Pier 21. This is a facility in a historic Port Authority building situated directly on Halifax Harbour. Huge windows overlook passing cruise ships and fishing trawlers.

Ceilidh (pronounced kay-lee) is Gaelic for party or gathering, and if you listen closely, you may hear the heart-stirring music of the fiddle or the echo of the bagpipe! It's a time for celebration, and you're invited.

Cost per person: \$60.00 (plus HST).

Optional, but not to be missed!



Tuesday 3 June 2008



08:00 – 16:30	Registration	Level 1, WTCC
07:00 – 08:30	Dalhousie University Department of Community Health and Epidemiology Breakfast	Room 100, WTCC
07:00 – 08:30	Breakfast and Town Hall Meeting Prevention of Violence Canada	Suite 301, WTCC
07:00 – 08:30	University of Toronto Public Health Sciences Alumni Association Breakfast	Suite 101, WTCC

09:00 – 10:00 **Plenary III** ♻️ **Halifax Metro Centre**

International Perspectives on Socio-economic Inequality and Population Health

The relationship between socio-economic status and health outcomes continues to be one of the most enduring areas of focus for both researchers and policy/decision-makers. This plenary will examine, from an international perspective, income inequality and population health. Johan Mackenbach will discuss a number of issues related to income inequality such as: Should the focus be on minimizing poverty or more broadly on reducing income inequality across the gradient? Strategies from other countries to reduce socio-economic inequalities in health and the diverse challenges confronting policy/decision-makers will also be examined.

Speaker

- ♣️ Johan Mackenbach, Professor of Public Health and Chair of the Department of Public Health at Erasmus MC, University Medical Centre Rotterdam, The Netherlands

Moderator

- ♣️ Cordell Neudorf, Chief Medical Health Officer/Vice President, Saskatoon Health Region



10:00 – 10:30 **Refreshment Break** **Room 200, WTCC**
Sponsored by the Nova Scotia Health Research Foundation

10:00 – 15:00 **Exhibits & Poster Presentations** **Room 200, WTCC**
Delegates are encouraged to visit the exhibits and posters to see the latest products and publications relating to all facets of public health and to learn more about the work being carried out by conference partners, the private sector, government departments, agencies and non-governmental organizations.

Tuesday 3 June 2008

10:30 – 12:00

Thematic Sessions

Addressing Inequalities in Health Through Intersectoral Action

Suite 301, WTCC

Substantial inequalities in health status and in access to social and health services continue to be priority issues for the health sector in Brazil, particularly for those living in the periurban and rural areas. The Intersectoral Action for Health Project, an initiative managed by CPHA in association with the National School of Public Health (ENSP/FIOCRUZ), the Brazilian public health association (ABRASCO) and institutional partners in six municipalities, seeks to contribute to the Government of Brazil's recently launched Mais Saúde (More Health) program by enhancing local capacity in health promotion through intersectoral action as a tool for local sustainable development. The purpose of this session will be to share the achievements to date and lessons learned in applying an intersectoral approach to health promotion in low-income communities in Brazil.

Speakers

- ✦ Antonio Ivo, Dean, National School of Public Health (Rio de Janeiro, Brazil)
- ✦ Alvaro Matida, Executive Director, ABRASCO (Rio de Janeiro, Brazil)
- ✦ Simone Moyses, University of Paraná and Local Coordinator (Curitiba, Brazil)
- ✦ Dais Gonçalves, Local Coordinator (Goias, Brazil)

Moderator

- ✦ Helena Monteiro, Coordinator, CPHA Intersectoral Action for Health (Canada/Brazil) Project

Housing

Suite 302, WTCC

Housing has been identified as a key socio-economic determinant of health. It is characterized as both a physical and social environment, which can have profound effects on the health of different populations (e.g., lone mothers and their children, homeless, etc.). The relationship between the socio-economic dimensions of housing and health inequalities has also been the subject of recent research, as has its potential impact on such health outcomes as mental health. This session will explore program and policy efforts underway calling for affordable, stable and adequate housing to meet diverse population needs, and the different housing interventions required in urban neighbourhoods, on-reserve and in other community settings to address this growing concern.

Speakers

- ✦ Jim Dunn, Research Scientist, Centre for Research on Inner City Health, St. Michael's Hospital; Assistant Professor, Department of Geography, University of Toronto
- ✦ Derek Ballantyne, CEO, Toronto Community Housing Corporation
- ✦ Duncan C. Maclennan, Professor of Urban Policy, University of Ottawa; Chief Economist, Infrastructure Canada

Moderator

- ✦ Erica Di Ruggiero, Associate Director, CIHR-IPPH

Chronic Disease Prevention and Inequities: Visions for the Future

Suite 303, WTCC

A major public health challenge facing Canada today is to substantially reduce the threats posed by chronic disease and the related health inequalities. Chronic disease efforts in public health, primary care and community services have tended to move along parallel tracks. While there are many examples of building linkages and coordinating efforts across the continuum, system-wide efforts remain limited. There is now growing interest in "thinking like a system" in order to more effectively address the social determinants of health through coordinated action and the realignment of priorities. Come to this session where panelists and participants will be challenged to envision a Canada that is a world leader in reducing the burden of chronic disease. What could the future look like? What is the role of public health?

Speakers

- ✦ John Millar, Executive Director, Population Health Surveillance and Disease Control, Provincial Health Services Authority, British Columbia
- ✦ Kimberly Elmslie, Director General, Centre for Chronic Disease Prevention and Control, PHAC
- ✦ Nancy Hoddinott, Director, Chronic Disease and Injury Prevention, Nova Scotia Department of Health Promotion and Protection
- ✦ Kari Barkhouse, Chronic Disease Prevention Coordinator, South Shore Health, Public Health Services

Moderator

- ✦ Jane Farquharson, Chief Executive Officer, Heart and Stroke Foundation of Nova Scotia

Tuesday 3 June 2008



10:30 – 12:00

Oral Abstract Presentations

Immigrant and Migrant Health - I

Suite 201, WTCC

- Development of a Framework to Examine the Determinants of Health among Canadian Immigrants – *Marie DesMeules*
- Studying Intra-metropolitan Health Disparities in Canada: How and Why Globalization Matters – *Ted Schrecker*
- To Describe the Migration, Health and Equity Issues for Canada in the Context of Global Migration Trends – *Janet Hatcher Roberts*
- Using Administrative Data to Analyse the Health Experience of African Nova Scotians – *Mikiko Terashima* 🇨🇦

Evaluating Our Progress in Healthy Eating and Active Living

Suite 202, WTCC

- Physical Activity in Seniors: Does Perception Match Reality? – *Deborah Weiss* 🇨🇦
- A Longitudinal Analysis of Physical Activity and Overweight/Obesity in Adolescents in Saskatoon – *Hang Lai* 🇨🇦
- Cost-effectiveness of the VERB Physical Activity Awareness Campaign – *Jennie Petersen* 🇨🇦
- Evaluation of the Northern Fruit and Vegetable Pilot Program – A Randomized Controlled Trial – *Meizi He*

Examining the Social Determinants of Health - II

Suite 203, WTCC

- Tackling Population Health – *Wilbert J. Keon*
- A Review of the Literature from the WHO Commission on the Social Determinants of Health – *Colleen Davison*
- The Public-private Healthcare Debate: Applying the Determinants of Health Lens and Identifying Key Roles for Public Health – *Chris Mackie* 🇨🇦
- Making the Shift to the Determinants of Health in a Local Public Health Unit – *Christine Post*
- Barriers to Addressing Inequalities in Health: Insights from the Canadian Experience – *Dennis Raphael*

Knowledge Transfer: Tools and Strategies

Suite 204, WTCC

- Implementing a Knowledge Cycle for Best Practices in Health Promotion and Chronic Disease Prevention – *Kerry Robinson*
- Health and Inequality Impact Assessment (HIIAS) as a Tool to Work on Healthy Public Policy – *Louise St-Pierre*
- Public Health Messaging and Program Delivery: An Ethical Approach – *Heidi Piovoso*
- Emerging Infectious Disease Detection and Response: Clinical Tools and Strategies on the Leading Edge – *Patricia Huston*
- Current Public Health Agency of Canada (PHAC) Initiatives in Chronic Disease Risk Factor Local-Area Surveillance and Risk Assessment – We Appreciate Your Input – *Marie DesMeules*

On the Move: Neighbourhoods and Networks

Suite 304, WTCC

- Moving Right Along: Transportation, Public Health and Social Equity – *Sherrill Johnson*
- The Public Life of Older People: Neighbourhoods and Networks – *Paula Gardner* 🇨🇦
- The Relationship between Perceived Neighbourhood Walkability and Neighbourhood-specific Walking Among Calgarian Adults: Preliminary Findings from the EcoEUFORIA Project – *Gavin McCormack*
- *in motion* to *en mouvement*: Reducing Health Inequalities with the Francophone Population Through a Physical Activity Health Promotion Strategy – *Linda Martin*
- Caractéristiques des usagers montréalais qui présentent une grande morbidité – *Mamadou Bamba Hanne*

Women's Health Issues

Suite 305, WTCC

- Gender-based Analysis: A Tool for Evidence-based Research in Occupational Health? – *Sue Street* 🇨🇦
- Measuring the Psychosocial Quality of Women's Family Work: Initial Findings – *Tamara Colton* 🇨🇦
- Access to Breast Cancer Screening in Nova Scotia – *Stephanie Lea* 🇨🇦
- Building Community Capacity to Increase Cervical Screening Participation in Underscreened Ontario Women – *Robbi Howlett*
- Inequities in Health and Health Care for Black Women – *Josephine Etowa*

Tuesday 3 June 2008

Chronic Disease Prevalence and Prevention - I

Suite 306, WTCC

- Sustainability for Community-wide Cardiovascular Disease Prevention: The Cardiovascular Health Awareness Program + Action Plan – *Tina Karwalajtys*
- Making the Links between Chronic Disease and Injury Prevention: An Essential Step in Advancing Injury Prevention in Canada – *Julian Young*
- Aboriginal Diabetes Initiative and the CIRCLE Study – *Mariam Naqshbandi*
- Learning Primary Health Care to Serve Adults with Developmental Disabilities – *Brian Hennen*
- The Prevalence of Depressive Symptoms in Canadians at Midlife – *Conita Kit Ching Ip* 🇨🇦

Youth Sexual Health

Suite 101, WTCC

- Improving Young Men's Experiences with STI Testing Services – *Rod Knight*
- Discourses on Improving Youth Sexual Health – *Jean Shoveller*
- A Social Focus on Youth Sexual Health – *Jean Shoveller*
- Which Comes First: Sexual Exploitation or Other Risk Exposures Among Street-involved Youth? – *Elizabeth Saewyc*
- Hard to Spell, Easy To Catch: A Sexual Health Social Marketing Campaign for Youth – *Rosie Mishael*

10:30 – 12:00

Workshops

Environmental Justice in Canada?

Suite 205, WTCC

Identifying a Role for Public Health Research and Practice

Jeffrey Masuda

New Approaches to Public Health Advocacy

Room 100, WTCC

Edward Bruce

12:00 – 13:00

Lunch

Free Time!

13:00 – 14:30

Plenary IV 🇨🇦

Halifax Metro Centre

Canadian Commentary on Reducing Health Inequalities

(continuation of Plenary II)

This interactive panel will be a continuation of Plenary II and will feature a dialogue on how Canada can be poised to take action in specific areas, based on the evidence.

Speakers

- Monique Bégin, Commissioner from Canada, WHO Commission on Social Determinants of Health
- Arjumand Siddiqi, Assistant Professor, Department of Health Behavior and Health Education, School of Public Health, University of North Carolina
- Sharon Chisholm, Executive Director, Canadian Housing and Renewal Association

Moderator

- Sharon Manson Singer, President, Canadian Policy Research Networks



14:30 – 15:00

Refreshment Break

Room 200, WTCC

Sponsored by the Nova Scotia Health Research Foundation

Tuesday 3 June 2008



15:00 – 16:30

Thematic Sessions

Understanding Rural Health in Canada

Suite 301, WTCC

This session will explore place-based determinants of health inequalities in rural, remote and northern communities and will highlight recent findings from a major study entitled "Canada's Rural Communities: Understanding Rural Health and Its Determinants" that was funded by the Canadian Population Health Initiative. Policy and program development (i.e., community-specific and regional level interventions tailored to the unique needs of rural residents) will also be discussed.

Speakers

- Marie DesMeules, PHAC
- Roger Pitblado, Centre for Rural and Northern Health Research, Laurentian University
- Judith Read Guernsey, Atlantic RURAL Centre, Dalhousie University

Moderator

- Victor Maddalena, Assistant Professor, School of Health Services Administration, Dalhousie University

Understanding Mental Wellness

Suite 302, WTCC

This session will discuss what factors contribute to overall mental wellness, issues related to stigma, and what factors contribute to a lack of mental health. Mental health can be influenced by various determinants of health, including individual, physical, social, cultural, and socio-economic characteristics. These and other factors can influence mental health in complex ways that are not always well understood. By focusing on specific groups within the population, we will further explore these links.

Speakers

- Gillian Mulvale, Senior Policy Advisor, Mental Health Commission of Canada
- Bill Mussel, Private Consultant
- Jean Harvey, Director, CPHI-CIHI

Moderator

- Carol Brule, CPHI-CIHI

15:00 – 16:30

Oral Abstract Presentations

Focus on Children's Health

Suite 201, WTCC

- Caregiving in the Context of Intersecting Inequities: African Nova Scotian Women – *Barbara Clow*
- Children Immigrants' Risk of Physical Inactivity According to Family Origin and Length of Residency – *Mathieu Bélanger* 🇫🇷
- The Impact of Aboriginal Early Childhood Programming on the Determinants of Health – *Conrad Saulis*
- In the Steps of Children: Reducing Health Inequalities of Indigenous Peoples in Canada by Refocusing on the Social Determinants of Health and Holistic Approaches and the Wellness of Generations – *Margo Greenwood*
- Effect of the Self-sufficiency Project on Children – *Piotr Wilk*

Reducing Inequities: Community Systems and Support

Suite 202, WTCC

- Health Disparity in Saskatoon: Analysis to Intervention – *Mark Lemstra*
- The Health Equity Mapping Project: One Step in the Development of a Local Public Health Strategy to Reduce Health Inequities – *Stephanie Lefebvre*
- Mixing Policy and Activism: The Poor and Sick Need to Eat Too – *Rebecca Green* 🇫🇷
- The Street Health Report 2007: Research for Social Change – *Kate Mason*
- A Canadian Community of Practice in EcoHealth: Building Capacity for Ecohealth Research, Practice and Decision-making to Address the Determinants of Health and Sustainability – *Margot Parkes*

Tuesday 3 June 2008

Chronic Disease and SES: What is the Connection?

Suite 203, WTCC

- Socio-economic Status and Smoking in Canada, 1999-2006: Has There Been Any Progress on Disparities in Tobacco Use? – *Jessica Reid* 🇨🇦
- Prévalence des troubles de l'anxiété et de l'humeur chez les travailleurs référés pour une investigation d'asthme professionnel – *Hélène Favreau*
- Historical Trends in the Social Determinants of Physical Inactivity, 1994-2005: Moving Health Policy to Prevent Chronic Disease in Canada – *Robert Hawes* 🇨🇦
- Les réseaux Santé français comme leviers essentiels d'amélioration de la santé des francophones du Canada – *Gilles Vienneau*
- Mapping the Role and Functions of Public Health in Chronic Disease Prevention and Control: What Are We Missing? – *Kerry Robinson*

Youth Health and Youth Empowerment

Suite 204, WTCC

- Addressing Health Inequalities among Girls and Young Women in Canada – *Carol Kauppi*
- Pregnancy in Teenage Women: Health Behaviours and Social Circumstances – *Deshayne Fell*
- Youth Empowerment in Junior High Schools: A Population Health Approach – *Janice Dempsey-Stewart*
- Examples of Youth Empowerment in Junior Highs Using a Population Health Approach: A New Public Health Initiative – *Janice Dempsey Stewart*
- School Surveillance: Active, Passive or a Combination? – *Beverly Billard*

Collaboration and Partnership: Key Strategies for Public Health

Suite 304, WTCC

- Building Champions to Think "Outside of the Box" in an Increasingly Demanding Health System – *Racheal Surette*
- How Community Leadership and Municipal Engagement Can Effect Systems Change and Attribute to Healthy Communities – *Robert Stead*
- Social Cohesion/Social Capital as Crosscutting Determinant of Health: The Need for Intersectoral Policy Initiatives – *Val Morrison*
- Power of Partnerships – *Sharon Lawlor*
- Reducing the Gap: Evidence and Action – *Bonnie Hostrawser*

Communities and Social Change

Suite 305, WTCC

- Reducing Health Inequities by Enhancing the Development of Healthy Acadian and Francophone Communities of Atlantic Canada: PHAC Atlantic's Five Year Action Plan – *Susan LeBlanc*
- A Social Capital-based Population Health Intervention: Québec en forme – *Louise Bouchard*
- Community Influences Design of Inner City Primary Healthy Centre for Inner City Edmonton – *Delmarie Sadoway*
- Ethical Decision-making Processes Used in Funding Tailored Health Services – *Brian Evoy* 🇨🇦
- Environmental Influences on Older Adults' Ability to Engage Socially – *Suzanne Dupuis-Blanchard*

Families, Health Inequities and Health Outcomes

Suite 306, WTCC

- Household Food Insecurity Among Low-income Toronto Families: Implications for Social Policy – *Sharon Kirkpatrick* 🇨🇦
- Supporting High Priority Families: Lessons from Rural and Northern Public Health Nursing – *Martha MacLeod*
- "Mind the Gap": Which Manitoba Health Outcomes Show Increased or Decreased Inequity Over Time, and What Programs are Associated with These? – *Patricia Martens*
- The Effect of Poor Housing Conditions on Health – *Claudia Jahn*
- Rethinking Health Inequities: The Case of Lone Mothers in Atlantic Canada – *Christine Saulnier*

Maternal Child Health

Suite 101, WTCC

- Enhancement of Prenatal Programming for First Nations: Two Approaches to the Roll-out of the Maternal Child Health Program – *Louise Cholock*
- Things I Wish I Had Known: An Innovative Community-based Prenatal Program – *Christine Hart*
- "Mothers are Not Machines" Perspectives of Religious Leaders, Health Professionals and Community Leaders About Family Planning in Pakistan – *Azmat Syed Khurram*
- Equity in Perinatal Healthcare of Migrant Women – *Carly Lang* 🇨🇦
- Spilt Milk: An Intersectoral Partnership that Failed to Advance Milk Security for Low-income Lone Mothers in Nova Scotia – *Lynn McIntyre*

Tuesday 3 June 2008



Aboriginal Peoples Health - II

Suite 205, WTCC

- The Determinants of Aboriginal Health in Canada: A Critical Population Health Approach – *Chantelle Richmond*
- Searching for 'Best' Practices in Aboriginal Health Programming and Service Delivery in Alberta – *Marcy Burka-Charles*
- The Manitoba Intergovernmental Committee on First Nations Health – *Peter Rogers*
- Integrated Management of Federal Responsibilities Under the Labrador Innu Comprehensive Healing Strategy – *Gail Baikie*
- Health Disparity in Saskatoon: Limited Association with Aboriginal Cultural Status – *Mark Lemstra*

15:00 – 16:30

Workshops

The Canadian Best Practices Initiative in Practice: A Contribution to Reduce Health Inequalities in Canada

Suite 303, WTCC

Nina Jetha

Adapt Not Adopt: The Application of Lessons on Intersectoral Action to a Canadian

Room 100, WTCC

Heather Fraser

Poverty and Oral Health in Canada: The Inconvenient Tooth

2nd Floor Boardroom, WTCC

Panelists

- Hazel Stewart, Director of Dental and Oral Health Services, City of Toronto
- Amanda Gillis, Oral Health Policy Advisor, Office of the Chief Dental Officer, Health Canada
- Joanne Clovis, Associate Professor, School of Dental Hygiene, Dalhousie University

Moderators

- Garry Aslanyan and Doug Brothwell, Canadian Association of Public Health Dentistry (CAPHD)

17:00 – 18:30



Canadian Public Health Association Annual General Meeting

Room 100, WTCC

CPHA's Annual General Meeting is open to all delegates at the conference; however, only CPHA members may vote. Prior to the start of the session, members are asked to check in at the AGM desk to obtain their voting cards. CPHA members whose membership has lapsed but who wish to attend the Annual General Meeting (AGM) and be eligible to vote may renew their membership just before the AGM. Anyone wishing to take out a new CPHA membership can do so at any time except on entry into the AGM.

19:00 – 21:00

Public Forum

Halifax Metro Centre

Poverty and Public Health – Exposing a Complex Relationship: A Dialogue

Welcome:

- Ron de Burger, Chair, CPHA Board
- Marie McCully-Collier, President, PHANS

Opening Remarks

- Lea Bryden, Vice President, Leadership, Marketing & Corporate Communications, Capital District Health Authority

Moderator

- Rob Strang, Chief Public Health Officer

Panelists

- Dennis Raphael, Professor and Undergraduate Program Director, School of Health Policy and Management, York University
- Megan Leslie, Community Legal Aid Worker, Dalhousie Legal Aid Service
- Bonnie Anderson, Public Health Nutritionist, Public Health Services, Capital District Health Authority
- Francisco Rico-Martinez, Director FCJ Refugee Centre, Toronto; Former President, Canadian Council for Refugees

Wednesday 4 June 2008

07:00 – 08:00 **CPHA Student Breakfast**  **Room 200 C1, WTCC**

07:00 – 08:00 **Immunization Hot Topics – Breakfast** **Suite 101, WTCC**
Individual roundtable discussions on optional topics

08:00 – 10:00 **Registration** **Level 1, WTCC**



08:30 – 10:00 **Thematic Sessions**

Health Inequalities and Infectious Disease

Suite 301, WTCC

Inequalities among different groups in Canada with respect to infectious diseases is a major challenge facing Canada today and warrants more focused attention. Every year, Canada welcomes approximately 250,000 immigrants and refugees, who arrive with different infectious disease profiles than persons born in Canada. Tuberculosis, HIV and some vaccine-preventable diseases are more prevalent in some of these groups. Other evidence indicates that differences in socio-economic status among all residents of Canada can result in different levels of immunization, along with varying incidences of STIs, tuberculosis, meningitis, hepatitis, and pneumonia. The speakers in this session will discuss the different dimensions of inequalities related to infectious diseases.

Speakers

-  Danielle Grondin, Director General, Policy Integration, Planning, Reporting and International Directorate Infectious Disease and Emergency Preparedness Branch, PHAC
-  Angus Dawson, Centre for Ethics, University of Toronto
-  Valerie Gideon, Regional Director, First Nations and Inuit Health, Health Canada - Ontario Region

Moderator

-  Denise Werker, Director, Migration and International Health, PHAC

Environmental Health and Inequalities: Evidence and Action

Suite 302, WTCC

Environmental issues are of critical interest to Canadians. The air we breathe, the water we drink, and the food we eat are all related to health. What, however, are the relationships between the environment and health inequalities? This session on environmental health will feature presentations related to “evidence and action” on health inequalities and environment, drawing on results and implications from recent “state of knowledge” papers. The speakers will discuss Aboriginal concepts of the environment and how to address challenges in environmental health issues within the context of First Nations communities.

Speakers

-  Stuart Wuttke, A/Director, Environmental Stewardship Unit, Assembly of First Nations
-  Tara Marsden, Research Associate, First Nations Environmental Health Innovation Network, National Collaborating Centre for Aboriginal Health, University of Northern British Columbia
-  Albert Marshall, Elder Advisor, Environmental Issues, Unamaki Institute of Natural Resources
-  Dominique Poulin, Program Manager, Drinking Water Task Force, Environmental Health Division, First Nations and Inuit Health Branch, Health Canada

Moderator

-  Judith Read Guernsey, Interim Head, Community Health and Epidemiology and Director, Atlantic RURAL Centre, Dalhousie University

Wednesday 4 June 2008



How Cities are Addressing the Social Determinants of Health and Health Inequalities!

Suite 303, WTCC

This session will explore population health in urban settings, with a focus on the role of cities in addressing social determinants of health and health inequalities. It will present some of the latest research on inequalities in health in Canadian cities, describe actual experiences, challenges and opportunities, and potential roles of cities in cross-sectoral action to address determinants of health. The structure of the session will involve presentations followed by dialogue related to how cities can be galvanized to take action on this issue.

Speakers:

- Councillor Sheila Fougere, Halifax Regional Municipality
- Cordell Neudorf, Chief Medical Health Officer, Saskatoon Health Region

Moderator:

- Brian Ward, Special Director to the Deputy Chief Public Health Officer, PHAC

08:30 – 10:00

Oral Abstract Presentations

Public Health Workforce Development

Suite 201, WTCC

- A Collaborative Approach to Workforce Development – *Kim Barro*
- Quality Clinical Placements in Public Health for Baccalaureate Level Nursing Students – *Christina Rajsic*
- Continuing Professional Competence: The Core of Workforce Development – *Robert Bradbury*
- Integration of Core Competencies and Community Health Nursing Standards into a Multi-disciplinary Environment – *Diane MacLean*
- Effecting Systems Change to Support Public Health Practice – *Jane Underwood*

Immigrant and Migrant Health - II

Suite 202, WTCC

- Meanings of Health, Illness and Help-seeking Strategies Among Punjabi-speaking Immigrants – *Beatrice McDonough*
- Psychoses-related Acute Hospital Discharges among a Large Canadian Immigrant Cohort – *Sarah McDermott* 🇨🇦
- Migration and Perinatal Health Surveillance: An International DELPHI Survey – *Anita Gagnon*
- Migration to Industrialized Countries and Perinatal Health: A Systematic Review – *Anita Gagnon*
- Childbearing Migrant Women and Equal Access to Research Participation – *Amy Low* 🇨🇦

Smoke-free: Are We There Yet?

Suite 203, WTCC

- Tobacco Attributable Hospitalizations in BC: Geographic Variations, Temporal Trends and Burden Relative to Alcohol and Illicit Drugs – *Jane A. Buxton*
- Smoking and Pregnancy: Status Profile 2007 – *Roberta Heale*
- Evidence-informed Tobacco Control Practice in Ontario Public Health Agencies – *John Garcia* 🇨🇦
- Parents' Perceptions of Barriers and Facilitators to Smoke-Free Homes/Vehicles – *Rosemary Herbert*
- Inspiring Partnership, Collaboration and Knowledge Transfer: Increasing Capacity to Address Health Inequities in Tobacco Use Before, During and After Pregnancy – *Phyllis Price*

Chronic Disease Prevalence and Prevention - II

Suite 204, WTCC

- Moving Beyond the Silos: Strengthening Chronic Disease Prevention and Management – *Lynn Chiarelli*
- Volunteer Peer Educator Role in a Community Cardiovascular Health Awareness Program (CHAP) – *Tina Karwalajts* 🇨🇦
- Diabetes, Comorbidities and Health Service Utilization among Miawpukek First Nation, Newfoundland and Labrador – *Kayla Collins*
- Improving Oral Health Outcomes through Community Partnership: Oral Cancer Screening in a High-risk Community – *Brenda Currie* 🇨🇦
- The Canadian Heart Health Strategy and Action Plan (CHHS-AP): A Case Study of Policy Development – *Eldon Smith*

Wednesday 4 June 2008

Early Childhood Development

Suite 304, WTCC

- Community Perspectives on Early Childhood Development among Ethnocultural Groups in the Greater Vancouver Area: A Cross-cultural Comparative Study – *Iraj Poureslami*
- Booster Seat Use in Ontario – *Piotr Wilk*
- Bridging Evidence and Practice: Developing a Series of Booklets for Parents of Children Birth to Three Years – *Jennifer Macdonald*
- L'innovation dans la collaboration école/communauté – *Francis Gagnon*
- Predictors of Child Health in Northern Ontario, Canada – *Darshaka Malaviarachchi*

Health Issues in High-risk Youth

Suite 305, WTCC

- Taking to the Streets: Healthy Sexuality and Risk Reduction Outreach Initiative – *Stephanie Vendetti*
- Adolescent Suicide in Canada: Trends in Occurrence between 1980 and 2004 – *Robin Skinner*
- Cultural and Contextual Determinants of Risky Sexual Behaviour among Adolescents in Low-income Slums in Mumbai, India – *Supriya Verma* 🇮🇳
- Primary Prevention of Suicide among Aboriginal Youth in Eastern Canada: Baseline Study and Research Process – *Dawn Caldwell*
- People, Places and Effecting Change in the Consumption of Fruit and Vegetables – *Ron Lemaire*

HIV and Harm Reduction

Suite 306, WTCC

- An Evidence-informed Approach to Enhancing the Distribution of Provincial Harm Reduction Supplies – *Jane Buxton*
- Overview of a Comprehensive Program for Injection Drug Users in Peel Living with or At-risk of Contracting HIV/AIDS and Other Bloodborne Infections – *Clare Hay*
- Inequities in Responding to HIV and Hepatitis C in Atlantic Canada – *Susan Kirkland*
- HIV/STI Outreach and Prevention: Building and Exchanging Knowledge for Reaching Vulnerable Populations – *Joyce Slater*
- Why Research Ethics Matter in International Settings: The Example of HIV/AIDS Research from a Canadian Perspective – *Jacqueline Gahagan*

Research to Practice: Moving Evidence to Action

Suite 101, WTCC

- Integrating Evidence and Action in Prevention: Directions of the Centre for Behavioural Research and Program Evaluation – *Roy Cameron*
- Strengthening Public Health Practice: Using the Core Competencies for Public Health – *Claire Betker*
- Balanced Scorecard Workplans: A Bridge between Research and Practice – *Cora Cole*
- SEARCHing Health Evidence for Health Action – *Ann Casebeer*
- Taking Stock: Synthesis of Aboriginal Health Policy – *Laverne Gervais*

Public Health Models, Frameworks and Programs

Suite 205, WTCC

- Interorganizational Health Networks as Agents for Systems Change – *Charmaine McPherson* 🇺🇸
- Evaluation of a Complex Mental Health Promotion Intervention: Revealing Health Inequalities and Limits to Evidence-based Policy and Practice – *Heather Rowe*
- The Use of a Population Health Measurement Conceptual Model to Develop a Partnership Model for a Regional Population Health Observatory – *Tracy Halbert*
- An "Enabling System" for Knowledge Development and Exchange in Public Health: A "What"?! – *Barbara Riley*
- Creation of the Healthy Development Evaluation Framework – *Kate Thompson*

08:30 – 10:00

Workshops

Engaging Employers: The Business Case for Investments in the Socio-economic Determinants of Health

Diana Mackay

Suite 200C1, WTCC

Best Practices in Improving the Health of Homeless People

Jim Zamprelli

Suite 100, WTCC

Wednesday 4 June 2008



10:00 – 10:30

Refreshment Break

Sponsored by the Nova Scotia Health Research Foundation

Halifax Metro Centre

10:30 – 12:00

Plenary V

Effective Systems Change

What is the evidence for effective system change both in health care and other sectors? There is increasing recognition that without addressing issues of system change that are both inter-disciplinary and inter-sectoral, little will change in reducing health inequities at the population level. This panel will introduce cutting-edge work from within and outside of the public health system in order to broaden our understanding of the larger systems in which local initiatives and programs are both imbedded and influenced.

Speakers

- ✦ Thomas Homer-Dixon, George Ignatieff Chair of Peace and Conflict Studies at the Trudeau Centre for Peace and Conflict Studies at the University of Toronto
- ✦ Ann Decter, Interim Director of Social Reform, Interim National Coordinator of Campaign 2000, Family Service Association of Toronto
- ✦ Robert Strang, Chief Public Health Officer, Nova Scotia Department of Health Promotion and Protection

Moderator

- ✦ Roy Cameron, Executive Director, Centre for Behavioural Research & Program Evaluation, University of Waterloo



Halifax Metro Centre

12:00 – 12:30

Call to Action and Closing Ceremony

Moderator

- ✦ Ron de Burger, Chair, CPHA

Halifax Metro Centre

Monday Poster Presentations

- 1 Impact of the Risk Scoring Model on the Cost-effectiveness of Palivizumab for Respiratory Syncytial Virus Prophylaxis in Premature Infants with a Gestational Age of 32-35 Weeks in Canada – *Shababa Masoud* 🇨🇦
- 2 Palivizumab Prophylaxis in Term Inuit Infants on Baffin Island, Nunavut: Can It Be Justified? – *Shababa Masoud* 🇨🇦
- 3 CARESS: The Canadian Registry of Synagis® – *Bosco Paes* 🇨🇦
- 4 Measuring Unmet Need in Cancer Screening Services in Canada – *Maia von Maltzahn* 🇨🇦
- 5 Alcohol and Other Drug Use: A Gendered Analysis – *Veeran-Anne Singh*
- 6 Slipping Through the Screen: Investigating the Factors Affecting Access to Regular Pap Tests among Vulnerable Women – *Erica Corbett* 🇨🇦
- 7 Promoting the Health of First Nations and Inuit Women and Infants – *Anne Guy*
- 8 Community Capacity Building: An Aboriginal Case Study – *Daniel McKennitt* 🇨🇦
- 9 Lone Parenthood, Working Hours, Work Schedules and Stress: Well-being and Health Challenges – *Jiri Zuzanek*
- 10 Moving Forward: Using Motivational Interviewing Techniques with Vulnerable Populations – *Sarah Ellis*
- 11 Migration and Cesarean Birth – *Isabelle St-Cyr* 🇨🇦
- 12 Oral Health Partners in Interprofessional Education: Enhancing Potential for Chronic Disease Management – *Joanne B. Clovis*
- 13 (Re)visioning Gender in Occupational Health Research – *Sue Street* 🇨🇦
- 14 Determining Issues of Public Health Significance in First Nations Populations: The Case for Rate Differences – *Jennifer Pennock*
- 15 Effectiveness of a Depression and Suicide Education Program for Educators and Health Professionals – *Magdalena Szumilas* 🇨🇦
- 16 L'insécurité alimentaire des ménages influence la perception des compétences pour cuisiner sainement des femmes atikamekw de Manawan – *Geneviève Mercille*
- 17 The Prevalence and Clustering of Multiple Chronic Disease Behavioural Risk Factors in Canadian Children and Adolescents – *Arsham Alamian* 🇨🇦
- 18 Towards Common Measurement of Eating Behaviour in Youth – *Rhona Hanning*
- 19 Study on Relationship between Earning Deciles and Life Expectancy among the Selected OECD Countries – *Zhiyong Hong*
- 20 Community-level Factors that are Associated with Food Sales, Availability, and Food Policy Implementation in BC Public Schools – *Kathryn Proudfoot* 🇨🇦
- 21 The Fatty in the Head Lines – *Nara Sudo*
- 22 Is SOS the Right Suicide Prevention Program for the Inuit Youths in Arctic Quebec? A Pilot Study – *Kianoush Dehghani*
- 23 Adolescent Parents and Their children: A Ten-year Retrospective Longitudinal Study of CAPC Participants – *Holly Charles*
- 24 Integrating Graphic Statistics and Social Networking Technologies into Public Health Outreach, Education and Practice – *Debra Godlewski*
- 25 Building Regional Capacity in the Development of Evidence-based Interventions for Cancer Prevention: Using Gaps Identified through a Funding Process – *Jose Mangles*
- 26 Geo-temporal Spread of Influenza A, Canada and United States – *Dena Schanzer*
- 27 Developing a Population-health Intervention to Fight Obesity – *Christine Stich*
- 28 The Social Determinants of Obesity in Canada, 2001-2005: Epidemiologic Evidence for Public Health Policy – *Robert Hawes* 🇨🇦
- 29 Best Foot Forward: The Chiropractic Profession's Program Strategy Aimed at Falls Prevention among Community-based Seniors – *Brian Gleberzon*
- 30 Cost-effectiveness of Dog Ownership on Cardiovascular Disease Healthcare Costs – *Michelle Fry*
- 31 Identifying Populations Utilizing Anonymous HIV Testing Clinics in Nova Scotia – *Tracey MacDonald*
- 32 Integrating Treatment and Prevention in HIV: Community Perspectives – *Eric Mykhalovskiy*
- 33 The Public's Knowledge of "Heart Attack" Symptoms – *Pamela Ratner*
- 34 Estimating the Effectiveness of a Rotavirus Universal Immunization Program with Rotateq in Canada – *Martin Sénécal*
- 35 Mapping System Changes Needed to Accelerate Actions towards the Prevention of Childhood Obesity – *Holly Buhler* 🇨🇦
- 36 The Effect of Humour in Web Communication Promoting Healthy Eating in Children 8 to 12 with Secure and Unsecure Attachment Styles – *Laurette Dubé*
- 37 Toward Multi-agent Interventions for Childhood Obesity Prevention: A Case Study Analysis of Long Live Kids – *Laurette Dubé*
- 38 Oral Cancer Screening: Lessons Learned from a Pilot Project – *Denise Laronde* 🇨🇦
- 39 Development of a Timely Respiratory Virus Detection System for Nova Scotia: Results 2005-2007 – *Assaad Al-Azem*
- 40 Lyme Disease Surveillance System in Nova Scotia – *Assaad Al-Azem*
- 41 Influenza Immunization: Are We Reaching Pregnant Women? – *Jeffrey Scott*
- 42 Exploring Options to Expand an MMR Immunization Program in Nova Scotia – *Shelly Sarwal*

Tuesday Poster Presentations



- 1 An Overview of Three Comprehensive School-based Sexuality Education Resource Manuals (Grades 4 through 10) – *Alice-Simone Balter*
- 2 Exploring Sexual Health Risk Experiences of Young Service Industry Workers in Alberta Mountain Park Communities through a Socio-ecological Framework – *Laurie Fownes*
- 3 The PALS Initiative – A Poverty Reduction Strategy for Health – *Leah Levac* 🇨🇦
- 4 Effectiveness of School-based Suicide Prevention Programs: A Meta-analysis – *Ainslie McDougall*
- 5 From Apprenticeship to the Workplace: Long-term Outcomes in a Cohort Exposed to Allergenic Agents – *Sylvie Daigle*
- 6 Park Characteristics and Local Mortality on the Island of Montreal – *Catherine Paquet*
- 7 Pilot Comparative Personal/Indoor/Outdoor/Urban/Rural Exposure Studies for Ground-level Ozone (O₃) and Fine Respirable Atmospheric Particles (PM_{2.5}) – *Mark Gibson*
- 8 Residents' Everyday Lives and Coping Strategies in Sarnia, 'Chemical Valley', Ontario – *Odwa Atari* 🇨🇦
- 9 75 Ways to Enjoy Tuna or the Story of the North End Walkers – *Jessie Jollymore*
- 10 Exploring Patterns of Health Care Utilization among Canadian Rural Populations: An Analysis of the Canadian Community Health Survey Cycle 3.1 – *Emily Wilson* 🇨🇦
- 11 Feasibility and Challenges of Developing a Geographical Tool to Assess Pesticide Exposure – *Jillian Ashley-Martin*
- 12 A Comprehensive Review of the Health Effects of Fungicides – *Jillian Ashley-Martin*
- 13 Making Schools Safer for All: Establishing Gay Straight Alliance Groups in High Schools – *Caryll Tawse*
- 14 Mind the Gap: Rural-urban Health Disparities among Sexual Minority Youth in BC – *Elizabeth Saewyc*
- 15 Achieving Healthy Body Weights in the Teenage Years: Evidence-based Practice Guidelines for Community Nutrition Interventions – *Theresa Glanville*
- 16 A GIS Analysis of Reported Spousal Violence in Calgary, AB – *Chantal Hansen*
- 17 The Sense Project: Changing the Culture of Sexual Health in Schools – *Christina Foisy*
- 18 Housing and Health Toolbox for Children and Youth Workshop: Tools to Address Housing and Health Issues in Clinical Practice – *Jama Watt*
- 19 A Website with a Content Management System Facilitates a Health Promotion Community Coalition – *Christine Senson*
- 20 Infant Mortality in Canadian Public Health Research – *Leah Walz* 🇨🇦
- 21 Partnering with Migrant Friendly Organizations: Development of a More Comprehensive 'Global Health' Curricula for Healthcare Students – *Jason Hickey* 🇨🇦
- 22 Setting Priorities for New Immunization Programs: A Novel Approach Utilizing the Opinions of Public Health Professionals – *Shelly McNeil*
- 23 Building Capacity in Marginalized Pregnant and Parenting Women – *Marilyn Young*
- 24 Comparison of Euclidean, Manhattan, and Road Network Distance in a Large Canadian City in the Context of Geographic Planning of Health Services – *Rizwan Shahid* 🇨🇦
- 25 Building Partnerships: Addressing Poverty Reduction – *Bonnie McGraw*
- 26 Enjeux organisationnels et pratique infirmière en première ligne : étude de cas de la prise en charge de personnes immigrantes et vulnérables au Québec – *Lara Maillet*
- 27 Towards a New Ethics for Public Health Research – *Jan Sutherland*
- 28 The National Collaborating Centre Methods and Tools: Impact on Public Health Policy and Practice – *Helen Thomas*
- 29 Exploring Civil Society Leadership to Advance Action on the Social Determinants of Health – *Susan McCunn*
- 30 Discipline Competencies for Dental Public Health Professionals – *Susanne Sunell*
- 31 Bringing e-Health to Public Health – *Heidi Brown*
- 32 Effectiveness of an Infant Nutrition Self-directed Learning Tool for Public Health Nurses – *Darshaka Malaviarachchi*
- 33 Celebrate What's RIGHT with the World! – *Thelma Messer*
- 34 Community-based Needs Assessments: Building a Determinants of Health Community Profiling and Comparison Tool, A Progress Report – *Verle Harrop*
- 35 A Pan-Canadian Survey of Community Health Nurses' Continuing Education Needs: Phase 1: Strengthening the Quality of Community Health Nursing Practice – *Ruth Schofield*
- 36 Collaborative Approaches to Healthy Eating in Nova Scotia – *Michelle Amero*
- 37 ATV Injuries among Newfoundland and Labrador Residents – *Heather Watkins*
- 38 Development of a Method to Measure Skills in Evaluating Health Information – *Brenda Kwan*
- 39 Healthy Settings for Young People in Canada – *Frank J. Elgar*
- 40 Smoke-free Outdoor Spaces Policy – *Jenna Clarke* 🇨🇦
- 41 Strengthening Evidence for Early Childhood Health Programming through Strategic Data Collection and Exchange – *Michelle Pickles*
- 42 The Development of Community Health Indicators: A District-wide Approach – *Edward Kinley*
- 43 The Canadian Best Practice Initiative: A System for Classifying Interventions – *Nina Jetha*
- 44 Core Competencies for Medical Officers of Health in Canada – *Hilary Robinson*
- 45 Assessing the State of Adult Vaccination Programs in Ontario: Where Can We Make Progress? – *Barry Pakes* 🇨🇦
- 46 Shaping Public Health Practice in the 21st Century: Core Competencies for Public Health in Canada – *Claire Betker*
- 47 Online Learning: A Practical Resource for Public Health in the 21st Century – *Jennifer Lowe*
- 48 Patient Wait Time Guarantees: Effecting System Change through First Nations Pilot Projects? – *Judy Watson*
- 49 Effecting Systems Change through an Innovative Approach to Evidence-based Reviews – *Paddy Murphy*
- 50 Structural and Institutional Forces that Shape Health Care Practitioners' Encounters with People who are Hepatitis C Positive – *Geri Hirsch*
- 51 An Open-source Model for Automated Public Health Surveillance Systems: The Case of the Nova Scotia Breast Screening Program – *Sam Stewart* 🇨🇦
- 52 Challenges in Fieldwork Experienced During a Prospective Cohort Study on HIV and Breastfeeding in Kabarole District, Uganda – *Esmé Lanktree* 🇨🇦
- 53 Projecting the Future Burden of Diabetes in Alberta (2006-2036) – *Robin Lau* 🇨🇦

Exhibitors

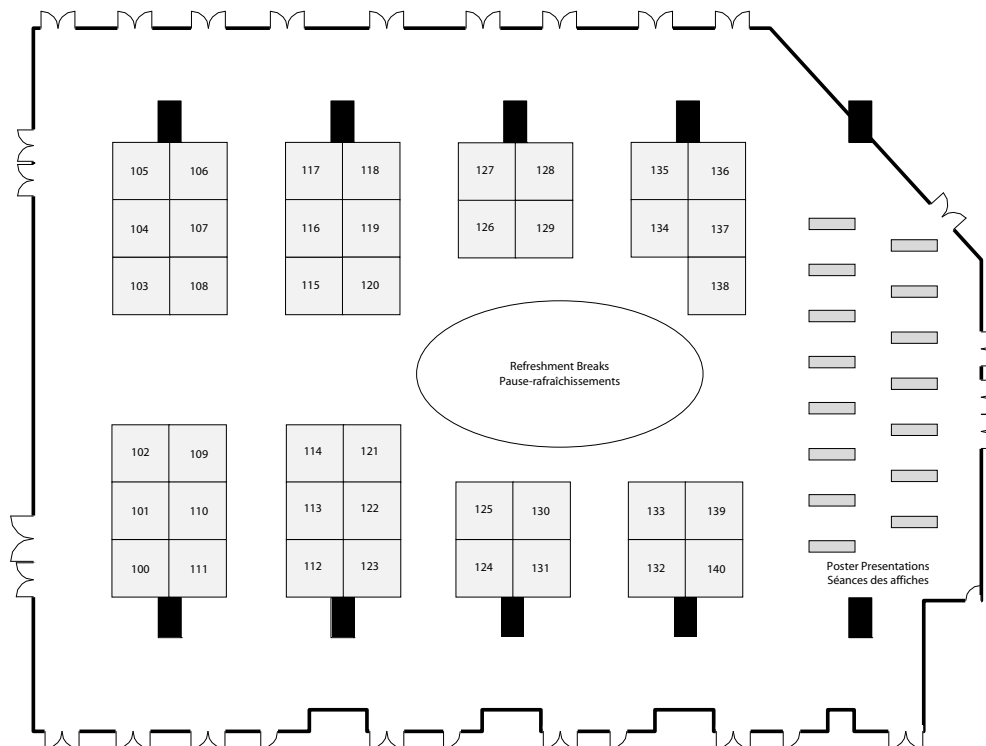

- | | | | |
|-----|--|-----|--|
| 100 | Clinidata, a division of Sykes Assistance Services | 121 | sanofi pasteur |
| 101 | Lakehead University | 122 | Human Early Learning Partnership (HELP) |
| 102 | Health Promotion Clearinghouse (Dalhousie) | 123 | London School of Hygiene and Tropical Medicine |
| 103 | Society of Obstetricians and Gynecologists | 124 | Chronic Disease Prevention Alliance of Canada |
| 104 | Réseau de recherche en santé des populations du Québec | 125 | ESRI Canada |
| 105 | | 126 | Public Health Agency of Canada |
| 106 | The Quaich Inc. | 127 | Public Health Agency of Canada |
| 107 | StepsCount | 128 | Public Health Agency of Canada |
| 108 | Canadian Chiropractic Association | 129 | Public Health Agency of Canada |
| 109 | Nycomed Canada Inc. | 130 | Merck Frosst |
| 110 | Natural Resources Canada / GeoConnections | 131 | in motion |
| 111 | University of Waterloo | 132 | CPHA – National Programs |
| 112 | National Collaborating Centres for Public Health | 133 | CPHA – Global Health Programs |
| 113 | National Collaborating Centre – Determinants of Health | 134 | Reckitt Benckiser |
| 114 | | 135 | Queen's Printer Government Publications |
| 115 | Health Canada, Canada Vigilance | 136 | Canadian Institute for Health Information – Canadian Population Health Initiative |
| 116 | Health Canada, Tobacco Control Programme | 137 | Canadian Institutes of Health Research – Institute of Population and Public Health |
| 117 | Pan Canadian Health Network | 138 | National Collaborating Centre – Healthy Public Policy |
| 118 | Pandemic Influenza Laboratory Preparedness Network | 139 | CPHA – Canada's International Immunization Program |
| 119 | Canadian Public Health Laboratory Network | 140 | CPHA – Canadian Coalition for Immunization Awareness & Promotion |
| 120 | GlaxoSmithKline | | |

Committees



Conference Steering Committee

Erica Di Ruggiero, CIHR-IPPH (Co-Chair)
Debra Lynkowski, CPHA (Co-Chair)
Carol Brulé, CIHI-CPHI
Heather Fraser, PHAC
Michael Goddard, PHAC
Sandra Griffin, National Collaborating Centre for Aboriginal Health (until February 29, 2008)
Judy Guernsey, Dalhousie University (Scientific Review Committee Co-chair)
Elizabeth Gyorfi-Dyke, CIHI-CPHI (until March 2008)
Agatha Hopkins, Public Health Association of Nova Scotia
Lindsay Olmstead, PHAC
Lesley Poirier, National Collaborating Centre for the Determinants of Health
Lisa Sullivan, CIHI-CPHI (Scientific Review Committee Co-chair)
Ginette Thomas, National Collaborating Centre for Aboriginal Health (from March 1, 2008)
Sarah Viehbeck, Student Representative, University of Waterloo
Fiona Webster, CIHR-IPPH

Communications Committee

Adèle Blanchard, CIHR
Sara Coleman, PHAC
Caroline-Anne Coulombe, CIHI
Maureen Hartigan, PHAC
Christina Lawand, CIHI
Debra Lynkowski, CPHA
Holly Nathan, National Collaborating Centre for Aboriginal Health
Véronique Perron, CIHR
Kelly Steele, CPHA
Linda Young, PHANS

Public Forum Committee

Hope Beanlands
Cheryl Chisholm
Heather Christain
Holly Gillis
Agatha Hopkins
Ed Kinley
Michelle LeDrew

Tracy Lovett
Marie McCully Collier
Sharon Samland
Caryll Tawse
Gaynor Watson-Creed (Co-Chair)
Linda Young (Co-Chair)

Scientific Reviewers

Yemi Agboola, Public Health Agency of Canada
Arsham Alamian, Université de Montréal 🇨🇦
David Allison, Eastern Health
Yukiko Asada, Dalhousie University
Nathalie Auger, Institut national de santé publique
Robert Bastien, Direction de santé publique de Montréal-Centre
Paul Belanger, CIHR
Sherri Bisset, Université de Montréal 🇨🇦
Carol Brulé, CIHI-CPHI
Michael Cantinotti, McGill University and Direction de santé publique de Québec 🇨🇦
James Chauvin, Canadian Public Health Association
Jocelyne Courtemanche, City of Ottawa
Jennifer Cushon, University of Saskatchewan 🇨🇦
Colleen Davison, University of Ottawa 🇨🇦
Keith Denny, CIHI-CPHI
Denise DePape, Toronto Public Health
Jason Disano, CIHI
Maureen Dobbins, McMaster University
Tara Elton-Marshall, University of Waterloo 🇨🇦
Myriam Fillion, Université de Québec à Montréal 🇨🇦
Katherine Frohlich, Université de Montréal
Pamela Fuselli, The Hospital for Sick Children
John Garcia, University of Toronto
Julie Goulet, CIHI
Geoffrey Gurd, Public Health Agency of Canada
Robert Hawes, University of Ottawa 🇨🇦
Michael Hayes, Simon Fraser University
Jamie Hockin, Public Health Agency of Canada
Liz Janzen, Toronto Public Health
Ryan Kennedy, University of Waterloo 🇨🇦
Sara Kirk, Dalhousie University
Susan Kirkland, Dalhousie University
Donald B. Langille, Dalhousie University
Marielle Ledoux, Université de Montréal
Elisa Lloyd-Smith, University of British Columbia 🇨🇦
Catherine Mah, University of Toronto 🇨🇦
Elisabeth Martin, Université Laval 🇨🇦
Richard Mathias, University of British Columbia
Peggy McDonough, University of Toronto
Art McIntyre, CIHI
Lynn McIntyre, University of Calgary
Azar Mehrabadi, University of British Columbia
Isabelle Michel, Sudbury & District Health Unit
Cordell Neudorf, Saskatoon District Health
Bernie Paillé, Canadian Institute for Health Information
Véronique Pelletier, Hôpital Sainte-Justine
Daniel Rainham, Dalhousie University
Diana Ridgeway, CIHI
Danielle Rolfe, University of Toronto 🇨🇦
Kate Shannon, University of British Columbia 🇨🇦
Zena Sharman, CIHR
Kelly Skinner, University of Waterloo 🇨🇦
Andrea Smith, Dalhousie University 🇨🇦
Kelly Steele, Canadian Public Health Association
Mikiko Terashima, Dalhousie University
Bilkis Vissandjee, Université de Montréal
Elizabeth Votta, CIHI
Fred Wien, Dalhousie University

Student Award and Bursary Reviewers

Sandra Fitzpatrick, CIHR-IPPH (coordinator of review process)
Norman Giesbrecht, Centre for Addiction and Mental Health
Slim Haddad, Université de Montréal
Michael Hayes, Simon Fraser University
Shanthi Johnson, University of Regina
Catherine Mah, University of Toronto
Maureen Malowany, McGill University
Louise Potvin, Université de Montréal
Alan Shiell, University of Calgary
Sarah Viehbeck, University of Waterloo

Thank you!

We would like to thank everyone who contributed their knowledge and expertise to the planning and development of the concurrent sessions. We appreciate for your generous support.

Floor Plans

World Trade & Convention Centre

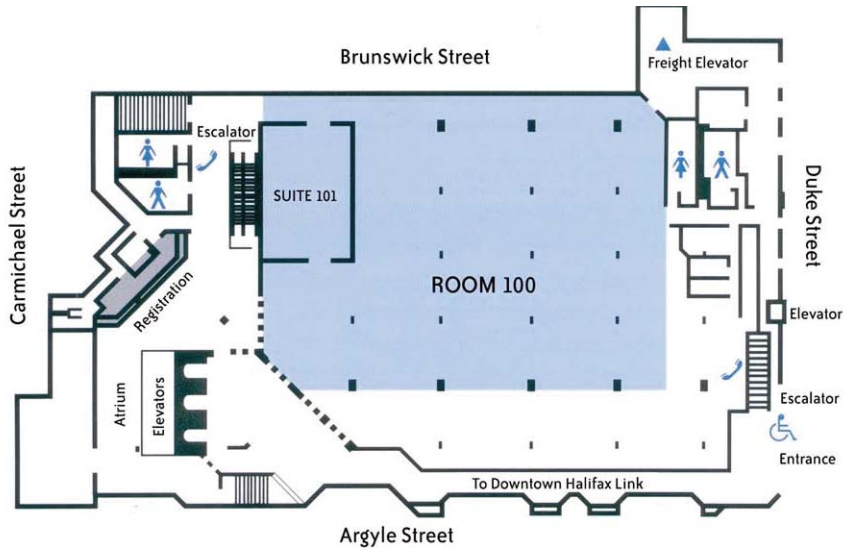

Level 1

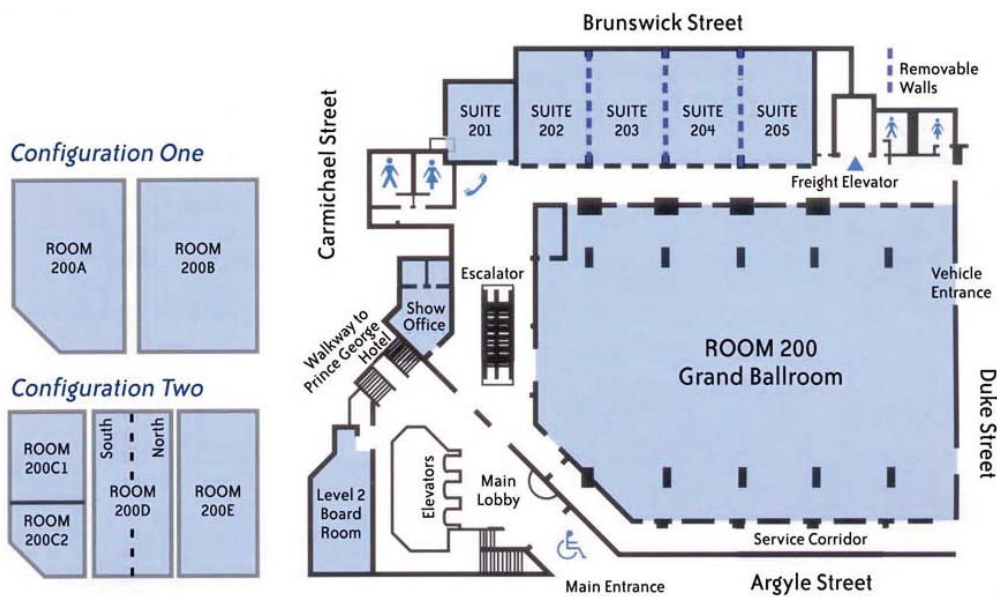

Level 2

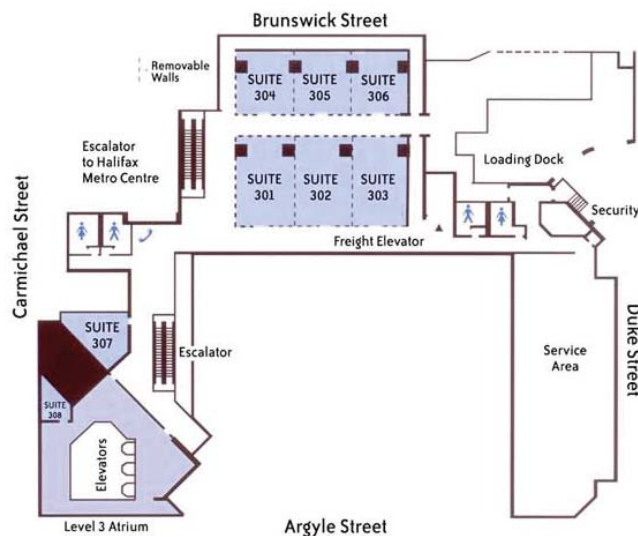

Level 3

Downtown Halifax

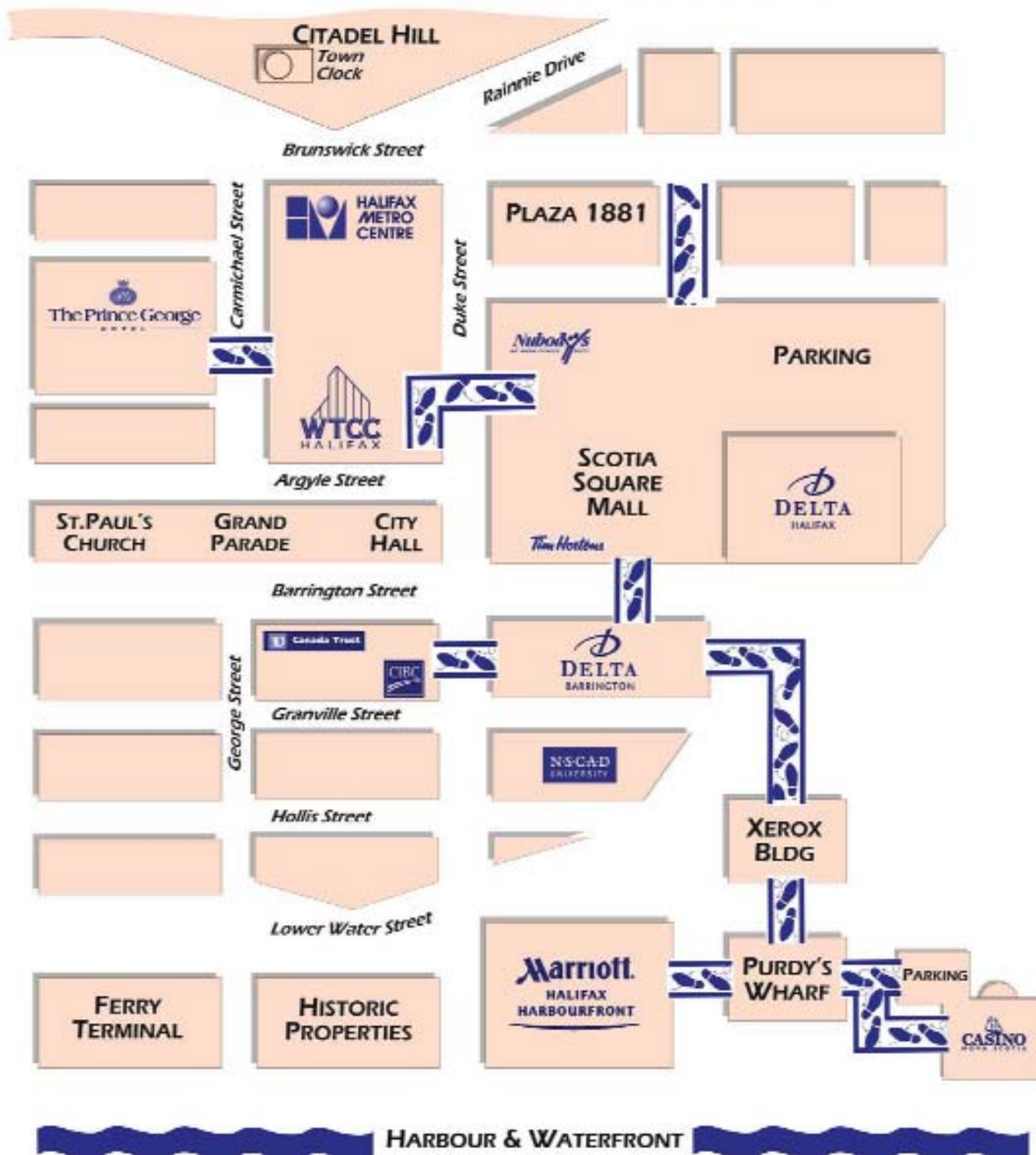



IBM and the IBM logo are trademarks of International Business Machines Corporation in the United States, other countries, or both, and are used under license by IBM Canada Ltd. Other company, product and services names may be trademarks or service marks of others. ©2007 IBM Corporation. All rights reserved.



YOU CAN SHAPE THE FUTURE OF MEDICINE

Today, organizations face a growing number of threats of disaster such as pandemics, ice storms and hurricanes. Pandemic preparedness is being addressed by organizations to better understand their potential exposure to an outbreak and how they can safeguard their employees and their operations.

IBM's Contingency Planning Assessment is designed to give organizations a better picture of the vulnerabilities they could face in the event of a widespread outbreak and assess the state of their readiness to react accordingly. The assessment is based on guidelines from the World Health Organization, the Centers for Disease Control and Prevention, Government, and decades of experience of IBM's crisis response team in managing actual disaster situations.

For more information visit: ibm.com/services

Help protect the ones you love from germs

LYSOL Wipes and LYSOL Disinfectant Spray Kill 99.9% of Germs*



*Based on a Canadian National Survey



LYSOL. Disinfect to Protect.



